



**Regional Manager, State Bank of India, Regional Business Office -1,  
Bhagu Road at Bathinda**

**INVITES TENDER**

**FOR**

**ELECTRICAL WORKS**

**AT STATE BANK OF INDIA**

**BO: TUNGWALI**

**TENDER DOCUMENTS**

**Date of issue of tender: 21.01.2022**

## NOTICE INVITING TENDERS

Sealed tenders (two envelope system) are hereby invited on behalf of **Regional Manager, State Bank of India, RBO-1, First Floor Bhagu road at Bathinda** for carrying out Electrical works at **TUNGWALI Branch PUNJAB**

**The only Empanelled Contractors are eligible to participate in this tender.**

Concepts of the tender are as under:

Part-1: Technical bid and

Part-2: Indicative commercial/price bids for captioned work shall be enclosed in two separate envelopes super-scribed with the respective contents (Technical Bid & Commercial Bid respectively) to be submitted on the same date and time.

The details of tender are as under:		
SN	Particulars	Details
1.	Name of work	<b>Electrical Works</b> for the <b>State Bank Of India, BO: Tugwali (Punjab)</b>
2.	Time allowed for completion	<b>45 days</b> from the date of commencement.
3.	Earnest Money Deposit	<b>10,000/-</b> (Ten thousands only) by crossed Bank draft/ Banker's cheque drawn in favour of State Bank of India payable at Bathinda.
4.	Security Deposit	<b>5%</b> of the accepted value of the contract including earnest money.
5	Retention money	Will be deducted at the rate of 10% of the respective running bill/final bill till 5% of the contract value and the same shall be held by the bank as total security deposit.
6.	Cost of tender documents	Nil
7.	Last date & time for submission of Technical Bid, <b>Indicative Price Bid</b> and EMD	<b>: 21-01-2022 on or before 1.00 pm.</b> Note: It is sole responsibility of the bidder to ensure submission of their Tender documents along with EMD by stipulated date and time at specified address failing which they will not be eligible to participate in Tendering process.
8.	Address at which the tenders are to be submitted	Hard copy of tender document (Technical and price bid) duly signed and stamped in a sealed covered and super scribed " <b>Tender for Electrical work in Tugwali Branch (PUNJAB)</b> " to be submitted at <b>Regional Manager State Bank of India, Regional Business Office-I, 1<sup>st</sup> floor Bhagu Road Bathinda</b> Mob: 9779586857
9.	Date and time of opening of tender	Offline <b>21.01.2022</b> at <b>02:00 PM</b>
10.	Place of opening tenders	offline
11.	Defects Liability Period	<b>12 months</b> from the date of completion
12.	Validity of offer	<b>90 days</b> from the date of opening of

		tenders.
13.	Liquidated Damages	At the rate of 0.5% of the contract value per week of delay subject to a maximum of 5% of the accepted contract value.
14.	Value of Interim certificate	2.5 lacs
15	Performance Security/Guarantee	Performance/Financial Bank Guarantee for an amount equivalent to 3% of the value of contract within 3 days from the date of issue of work order. The Bank guarantee will be valid for a period of 6 months or such other extended period as the Bank may decide for due performance undertaken by the successful bidder. <b>Annexure-I</b>
16	Additional security Deposit	In case L-1 bidder quotes abnormally low rates (i.e. 7.5 % or more, below estimated project cost), the bank may ask such bidder to deposit additional security deposit (ASD) equivalent to difference of estimated cost vis-à-vis L-1 quoted amount for due fulfillment of contract. Such ASD could be in the form of FDR / Bank's guarantee in the Bank's name as per format approved by the Bank. On successful completion of work ASD will be returned to the contractor. In case contractor fails to complete the work in time or as per tender specification or leave the job incomplete, the bank will be at liberty to recover the dues from ASD or to forfeit such ASD as the case may be within its sole discretion.
Electrical installation work has to be carried out through electrical contractor on bank's panel. An undertaking from electrical contractor in this regard shall be submitted along with the technical bid.		
In case the date of opening of tenders is declared as a holiday, the tender will be opened on the next working day at the same time.SBI has the right to accept/reject any/ all tenders without assigning any reasons.		
For and behalf of State Bank of India		

## **MODE OF SUBMISSION OF TENDER: OFFLINE TENDER**

The tender shall be submitted OFFLINE in two cover system in accordance with the procedure detailed herein below. Specified documents shall be sealed in envelopes of appropriate size each of which shall be sealed.

- a) 1) First Envelope marked cover-1 shall contain covering letter, clarification (if any), technical and commercial terms, duly signed and requisite Earnest Money Deposit along with Cost of Tender, is to be deposited at SBI, Regional Business office –I First Floor Bhagu road at Bathinda latest **by 21.01.2022 upto 01:00 PM.**
- 2) Second Envelope marked cover-2 shall contain only the copy of priced Bill of Quantities duly filled OFFLINE, duly signed, is to be deposited at SBI, Regional Business office –I First floor Bhagu Road at bathinda latest **by 21.01.2022 upto 02:00 PM.**

Opening of Tender:

- 1) OFFLINE
- 2) Cover 1 containing the Earnest Money Deposit covering letter, terms and conditions, if any, will be opened first.
- 3) After opening of cover 1 and after evaluating the clarifications / conditions, if any, stipulated by the contractors, i.e. if the vendor are qualified, cover 2 containing priced Tenderer will be opened OFFLINE of those qualified vendors
- 4) In case and only if the L-1 bidder quote received is substantially high (more than 10% of the estimated cost put to tender), Bank shall have the rights to carry out reverse auction which will be communicated as soon as possible after opening of e-tenders to all the qualified vendors/firms.

In case the date of opening of tenders is declared as a holiday, the tenders will be opened on the next working day at the same time.

State Bank of India has the right to accept / reject any or all tenders without assigning any reasons.

Yours faithfully,

-----S/d-----

Signature of the Tenderer

Regional Manager  
SBI, Regional Business office-I,  
Bhagu Road at Bathinda

## **INSTRUCTIONS TO THE TENDERERS**

### **1.0 SCOPE OF WORK**

OFFILINE Sealed Tenders are invited by State Bank of India, **RBO-1, First Floor Bhagu Road at Bathinda** for Electrical work at the **State Bank of India, TUNGWALI**.

### **1.1 SITE AND ITS LOCATION**

The proposed work is to be carried out at **State Bank of India, TUNGWALI**.

### **2.0 Tender documents**

2.1 The work has to be carried out strictly according to the conditions stipulated in the tender consisting of the following documents and the most workmen like manner.

- i) Instructions to Tenderers
- ii) General Conditions of Contract
- iii) Special conditions of contract
- iv) Additional condition for electrical installation
- v) Technical specifications
- vi) Price bid
- vii) Drawings

2.2 The above documents shall be taken as complementary and mutually explanatory of one another but in case of ambiguities or discrepancies, shall take precedence in the order given below:

- i) Price bid
- ii) Additional condition for electrical installation
- iii) Technical specifications
- iv) Instructions to the tenderer
- v) Special Conditions of Contract
- vi) General Conditions of Contract

2.3. Tender documents are not transferable.

### **3.0 SITE VISIT**

3.1 The tenderer must obtain himself on his own responsibility and his own expenses all information and data which may be required for the purpose of filling this tender document and enter into a contract for the satisfactory performance of the work. The tenderer is requested satisfy himself regarding the availability of water, power, transport and communication facilities, the character quality and quantity of the materials labour, the law and order situation, climatic conditions local authorities requirements, traffic regulations etc. The tenderer will be fully responsible for considering the financial effect of any or all the factors while submitting his tender.

### **4.0 Earnest Money Deposit**

- 4.1 The tenderers are requested to submit the Earnest Money of Rs.10,000/- (Rupees Ten thousands only) in the form of Demand Draft in favour of State Bank of India and payable at Bathinda and Cost of Tender documents of **Rs. 2000/- (Two thousand Only)** to be deposited through SBI Collect only by using SBI Internet Banking web-site [www.onlinesbi.com](http://www.onlinesbi.com)
- 4.2 EMD & Cost of tender in any other form other than as specified above will not be accepted. Tender not accompanied by the EMD & Cost of tender shall be rejected.
- 4.3 No interest will be paid on the EMD and cost of tender will be non-refundable.
- 4.4 EMD of unsuccessful bidders will be refunded within 30 days of award of Contract whereas cost of tender will be non-refundable.
- 4.5 EMD of successful bidder will be retained as a part of security deposit.

## 5.0 Initial Security Deposit

NIL

## 6.0 Retention Money

- 6.1 An amount @ 3% of the bill amount will be retained by the SBI from the bills and the same will be released by the SBI against Bank guarantee for equal amount issued by any Nationalized /Scheduled Bank in the SBI's approved format valid for 1 year. The Bank guarantee shall be released only after completion of warranty period of 1 year provided no complaint is received in the office chairs or the defects has been rectified by replacing the same satisfactorily.

*The successful bidder may choose to submit such Bank Guarantee to the SBI soon after commencement of work to avoid deduction of retention money from the Bills. No advance on materials / plant / machinery or mobilization advance shall be paid in any circumstances*

- 6.2 No interest shall be paid to the amount retained by the Bank as Security Deposit.

## 7.0 Signing of Contract Documents

The successful tenderer shall be bound to implement the contract by signing an agreement and conditions of contract attached herewith within 15 days from the receipt of intimation of acceptance of his tender by the Bank. However, the written acceptance of the tender by the Bank will constitute a binding agreement between the Bank and successful tenderer whether such formal agreement is subsequently entered into or not.

- 8.0 Completion Period **45 days** from the date of work order.

## 9.0 Validity of Tender

Tenders shall remain valid and open for acceptance for a period of 3 (Three) months from the date of opening price bid. If the tenderer withdraws his/her offer during the validity period or makes modifications in his/her original offer which are not acceptance to the Bank without prejudice to any other right or remedy the Bank shall be at liberty to forfeit the EMD.

## 10.0 Liquidated Damages

The liquidated damages shall be 0.5% per week subject to a maximum of 5% of contract value.

## 11.0 Rates and Prices

### 11.1 In case of item rate tender

11.1.1 The tenderers shall quote their rates for individual items both in words and figures in case of discrepancy between the rates quoted in words and figures the unit rate quoted in words will prevail. If no rate is quoted for a particular item the contractor shall not be paid for that item when it is executed. The amount of each item shall be calculated and the requisite total is given. In case of discrepancy between the unit rate and the total amount calculated from multiplication of unit rate and the quantity the unit rate quoted will govern and the amount will be corrected.

11.1.2 The tenderers need not quote their rates for which no quantities have been given. In case the tenderers quote their rates for such items those rates will be ignored and will not be considered during execution.

11.1.3 The tenderers should not change the units as specified in the tender. If any unit is changed the tenders would be evaluated as per the original unit and the contractor would be paid accordingly. The tenderer should not change or modify or delete the description of the item. If any discrepancy is observed he should immediately bring to the knowledge of the Architect/ Bank.

11.1.4 Each page of the BOQ shall be signed by the authorized person and cutting or overwriting shall be duly attested by him.

11.1.5 Each page shall be totaled and the grand total shall be given.

11.1.6 The rate quoted shall be firm and shall include all costs, allowances, taxes, VAT, levies, GST etc.

**12 Performance Bank Guarantee (BG):** The selected bidder would be required to submit a performance Bank Guarantee to the Bank for an amount equivalent to **3% of the value of contract** within 3 days from the issue of work order. The bank guarantee will be valid for a period of 6 months or such other extended period as the Bank may decide for due performance of the obligations undertaken by the successful bidder. The bank guarantee should be issued by any scheduled commercial bank, other than SBI. A format for BG is attached as per **Annexure-I**. The Performance Bank Guarantee is required to protect the interest of the Bank against the risk of non performance of the successful bidder or breach of performance of the conditions of the contract which may warrant invoking of Bank Guarantee (BG). Also, if any act of the Contractor results in imposition of Liquidated Damages then the Bank reserves the right to invoke the Performance Bank guarantee. The Performance Bank Guarantee can be forfeited by the bank in the event of any breach or negligence or non-observance of any condition of contract or for unsatisfactory performance or non-observance of any condition of the contract. Performance Bank Guarantee will be discharged after completion of contractor's performance obligations (including Warranty / Guarantee period) under the contract.

**DRAFT FORMAT OF BANK GUARANTEE IN LIEU OF SECURITY DEPOSIT  
“ELECTRICAL WORKS  
FOR STATE BANK OF INDIA TUNGWALI, PUNJAB”**

”

(Site specific format shall be approved by the SBI prior to its execution)

(To be submitted on Non-judicial stamp paper of appropriate value purchased in the name of the issuing bank)

B.G. No. \_\_\_\_\_ Value Rs. \_\_\_\_\_

Date:

**To**

The .....

State Bank of India,

.....

.....

Dear Sir,

Bank Guarantee of Rs \_\_\_\_\_ to wards Security Deposit for Electrical work at TUNGWALI.

WHEREAS (Name and address of contractor/ vendor) (hereinafter called the Contractor) have entered into contract (for Electrical work at TUNGWALI.)

for State Bank of India, ..... situated at BATHINDA ) with SBI as mentioned vide letter no..... dated .....and the correspondence and tender relating thereto which is hereinafter referred to as “the said contract” the Contractor has now agreed to produce a Bank Guarantee amounting to **3%** of the annual contract to SBI ..... for performing their part of the contract obligations.



AND WHEREAS in terms of said contract, the contractor is required to furnish to SBI ..... a Guarantee of a Scheduled Commercial Bank for a value of Rs..... to be valid upto (date).

AND WHEREAS (Name of Bank and its branch) having their office at (address) the Guarantor, at the request of the contractor hereby furnishes a Performance Bank guarantee in favour of SBI ..... and Guarantees in the manner hereinafter appearing. In consideration of the premise, we (name of Bank and its branch) having our office at (address) here after called the "Guarantor" (which expression shall include it successors and assigns) hereby expressly, irrevocably & unreservedly undertaken and guarantee under that if the Contractor fails to execute the work according to his obligations under the said contract, then notwithstanding any dispute between SBI ..... and the contractor, the Guarantor shall, on demand without demur and without reference to the contractor pay to SBI ..... immediately any sum claimed by SBI ..... under the said contract up to a maximum amount of Rs. \_\_\_\_\_ (Rupees only).

In case the amount demanded by SBI ..... is not paid within 48 hours of receipt of demand, the Guarantor agrees to pay the aforesaid amount of Rs...../- (Rupees ..... only).

Such payment shall be notwithstanding any right the contractor may have directly against SBI ..... or any disputes raised by the Contractor with SBI ..... or any suits or proceedings pending in any competent court or before any arbitrator. SBI's written demand shall be conclusive evidence to the Guarantor that such payment is payable under the terms of the Contract and shall be binding in all respect on the guarantor.

The Guarantor shall not be discharged or released from the undertaking and Guarantee, by any arrangement, variations made between SBI and the Contractor and or indulgence shown to the contractor by SBI, with or without the consent and knowledge of the guarantor or by alterations in the obligations of the contractor by any forbearance, whether as to payment, time performance or otherwise.

This guarantee shall remain valid until or as may be caused to be extended by the contractor or until discharged by SBI in writing whichever is earlier.

This guarantee shall be a continuing guarantee and shall not be revocable during its currency except with the previous written consent of SBI .....

This guarantee shall not be affected by any change in the constitution of the contractor, by absorption with any other body or corporation or dissolution or otherwise and this guarantee will be available to or enforceable against such body or corporation.

In order to give effect to this guarantee SBI will be entitled to act as if the Guarantor were the Principal debtor and the Guarantor hereby waives all and any of its rights or surety ship.

This guarantee shall continue to be in force notwithstanding the discharge of the contractor by operation of law and shall cease only on payment of the full amount by the Guarantor to SBI of the amount hereby secured.

This guarantee shall be in addition to and not in substitution for any other guarantee or security for the contractor given or to be given to SBI in respect of the said contract.

Any notice by way of request and demand or otherwise here under may be sent by post or any other mode or communication to the guarantor addressed as aforesaid and if sent by post it shall be deemed to have been given at the time when it would be delivered in due course of post and in providing such notice when given by post it shall be sufficient to prove that the envelope containing the notice was posted and a certificate signed by an officer of SBI that the envelope was so posted shall be conclusive.

These presents shall be governed by and constructed in accordance with Indian Law.

Notwithstanding anything contained herein before the liability of the guarantor under this guarantee is restricted to a sum of Rs. \_\_\_\_\_.

This guarantee will remain valid upto \_\_\_\_\_ unless a demand or claim under this guarantee is made in writing against us within three months from that date, i.e. on or before -----, the guarantor shall be discharged from all liability under the guarantee thereafter.

We have power to issue this guarantee in your favour under the Memorandum and Articles of Association of our bank and the undersigned has been duly authorised by the bank (bank issuing the Bank Guarantee) to execute this Guarantee Deed.

Dated the .....

SIGNED AND DELIVERED For & on behalf of (the above-named bank)

For & on behalf of (Bankers Name & Seal)

(Signature/s with designation/s of signatories)

(Banker's seal)

## **GENERAL CONDITIONS OF CONTRACT**

### **1.0 Definitions:**

“Contract” means the documents forming the tender and the acceptance thereof and the formal agreement executed between State Bank of India (client) and the contractor, together with the documents referred therein including these conditions, the specifications, designs, drawings and instructions issued from time to time by the Architects / Bank and all these documents taken together shall be deemed to form one contract and shall be complementary to one another.

1.1 In the contract the following expressions shall, unless the context otherwise requires, have the meaning hereby respectively assigned to them.

1.1.1 Bank or SBI or Architect or Consultant shall mean State Bank of India (client) through SBI having its Regional Business Office-1 Bhagu Road at Bathinda and includes the client’s representatives, successors and assigns.

1.1.2 “Site Engineer” shall mean an Engineer appointed by the SBI whether incorporated or not, undertaking the works and shall include legal personal representative to give instructions to the contractors.

1.1.3 “The Contractor” shall mean the individual or firm or company whether incorporated or not, undertaking the works and shall include legal personal representative of such individual or the composing the firm or company and the permitted assignees of such individual or firms of company.

The expression “works” or „work” shall mean the permanent or temporary work described in the “Scope of work” and / or to be executed in accordance with the contract and includes materials, apparatus, equipment, temporary supports, fittings and things of all kinds to be provided, the obligations of the contractor hereunder the work to be done by the contractor under the contract.

1.1.4 “Resident Engineer” shall mean the representative of the Architect / consultant.

1.1.5 “Drawings” shall mean the drawings prepared by the Architects and issued by the Engineer and referred to in the specifications and any modifications of such drawings as may be issued by the Engineer from time to time. „Contract value shall mean the value of the entire work as stipulated in the letter of acceptance of tender subject to such additions thereto or deductions there from as may be made under the provision herein after contained.

1.1.6 “Specifications” shall mean the specifications referred to in the tender and any modifications thereof as may time to time be furnished or approved by the architect / consultant “Month” means calendar month.

1.1.7 “Week” means seven consecutive days.

1.1.8 “Day” means a calendar day beginning and ending at 00 Hrs and 24 Hrs respectively

## **CLAUSE**

### **2.0 Total Security Deposit**

Total Security deposit comprise of:

Earnest Money Deposit

Retention Money

#### **a) Earnest Money Deposit**

The tenderer shall furnish. No tender shall be considered unless the EMD is so deposited in the required form. No interest shall be paid on this EMD. The EMD of the unsuccessful tenderer shall be refunded soon after the decision to award the contract is taken without interest. The EMD shall stand absolutely forfeited if the tenderer revokes his tender at any time during the period when he is required to keep his tender open acceptance by the SBI or after it is accepted by the SBI the contractor fails to enter into a formal agreement or fails to pay the initial security deposit as stipulated or fails to commence the work within the stipulated time

#### **b) Retention Money**

Besides the ISD as deposited by the contractor in the above said manner the retention money shall be deducted from the running account bill at the rate of 10% of the gross value of work done by the contractor and claimed in each bill provided the total security deposit i.e. the ISD plus Retention Money shall both together not exceed 3 % of the contract value. 50% of the total security deposit shall be refunded to the contractor without any interest on issue of Virtual Completion certificate by the Architect/consultant. The balance 50% of the total security deposit shall be refunded to the contractors without interest within fifteen days after the end of defects liability period provided the contractor has satisfactorily attended to all defects in accordance with the conditions of contract including site clearance.

### **3.0 Language Errors, Omissions and Discrepancies**

In case of errors, omissions and/or disagreement between written and scaled dimensions on the drawings or between the drawings and specifications etc, the following order shall apply.

- i) Between scaled and written dimension (or description) on a drawing, the latter shall be adopted.
- ii) Between the written or shown description or dimensions in the drawings and the corresponding one in the specification the former shall be taken as correct.
- iii) Between written description of the item in the specifications and descriptions in bills of quantities of the same item, the latter shall be adopted.
- iv) In case of difference between rates written in figures and words, the rate in words shall prevail.
- v) Between the duplicate/subsequent copies of the tender, the original tender shall be taken as correct.

### **4.0 Scope of Work**

The contractor shall carry out, complete and maintain the said work in every respect strictly in accordance with this contract and with the directions of and to the satisfaction of the Bank to be communicated through the architect/consultant. The architect/consultant at the directions of the Bank from time to time issue further drawings and/or written instructions, details directions and explanations which are hereafter collectively referred to as Architect's/Consultant's instructions in regard to: the variation or modification of the design,

quality or quantity of work or the addition or omission or substitution of any work, any discrepancy in the drawings or between the BOQ and/or drawings and/or specifications, the removal from the site of any material brought thereon by the contractor and the substitution of any other materials thereof, the demolition, removal and/or re-execution of any work executed by him, the dismissal from the work of any person employed/engaged thereupon.

#### **5 (i) Letter of Acceptance**

Within the validity period of the tender the SBI shall issue a letter of acceptance either directly or through the architect by Email / registered post or otherwise depositing at the address of the contractor as given in the tender to enter into a Contract for the execution of the work as per the terms of the tender. The letter of acceptance shall constitute a binding contract between the SBI and the contractor.

#### **5 (ii) Contract Agreement**

On receipt of intimation of the acceptance of tender from the SBI/Architect the successful tenderer shall be bound to implement the contract and within fifteen days thereof he shall sign an agreement in a non-judicial stamp paper of appropriate value.

#### **6.0 Ownership of drawings**

All drawings, specifications and copies thereof furnished by the SBI through its architect/consultants are the properties of the SBI. They are not to be used on other work.

#### **7.0 Detailed drawings and instructions**

The SBI through its architects/consultants shall furnish with reasonable promptness additional instructions by means of drawings or otherwise necessary for the proper execution of the work. All such drawings and instructions shall be consistent with the contract documents, true developments thereof and reasonably inferable there from.

The work shall be executed in conformity therewith and the contractor prepare a detailed program schedule indicating therein the date of start and completion of various activities on receipt of the work order and submit the same to the SBI through the Architect/Consultant.

#### **Copies of Agreement**

Two copies of agreement/tender document duly signed by both the parties with the drawings shall be handed over to the contractors.

#### **8.0 Liquidated Damages**

If the contractor fails to maintain the required progress in terms of clause 30 of GCC or to complete the work and clear the site including vacating their office on or before the contracted or extended date or completion without justification in support of the cause of delay, he may be called upon without prejudice to any other right of remedy available under the law to the SBI on account of such breach to pay a liquidated damages at the rate of 0.5% of the contract value per week subject to a maximum of 5% of the contract value.

#### **9.0 Materials, Appliances and Employees**

Unless or otherwise specified the contractor shall provide and pay for all materials, labour, water, power, tools, equipment transportation and any other facilities that are required for the satisfactory execution and completion of the work. Unless or otherwise specified all materials shall be new and both workmanship and materials shall be best quality. The contractor shall at all times enforce strict discipline and good order among his employees and shall not employ on the work any unfit person or anyone not skilled in the work assigned to him.

Workman whose work or behavior is found to be unsatisfactory by the SBI/Architect/Consultant he shall be removed from the site immediately.

### **10.0 Permits, Laws and Regulations**

Permits and licenses required for the execution of the work shall be obtained by the contractor at his own expenses.

The contractor shall give notices and comply with the regulations, laws, and ordinances rules, applicable to the contractor. If the contractor observes any discrepancy between the drawings and specifications, he shall promptly notify the SBI in writing under intimation of the Architect/Consultant. If the contractor performs any act which is against the law, rules and regulations he shall meet all the costs arising there from and shall indemnify the SBI any legal actions arising there from.

### **11.0 Setting out Work**

The contractor shall set out the work and shall be responsible for the true and perfect setting out of the same and for the correctness of the positions, levels, dimensions, and alignment of all parts thereof and get it approved by the architect/consultant before proceeding with the work. If at any time any error in this respect shall appear during the progress of the works, irrespective of the fact that the layout had been approved by the architect/consultant the contractor shall be responsible for the same and shall at his own expenses rectify such error, if so, required to satisfaction of the SBI.

### **12.0 Protection of works and property**

The contractor shall continuously maintain adequate protection, of all his work from damage and shall protect the SBI's properties from injury or loss arising in connection with contract. He shall make good any such damage, injury, loss due to his fault or negligence except which are due to causes beyond his control.

He shall take adequate care and steps for protection of the adjacent properties. The contractor shall take all precautions for safety and protection of his employees on the works and shall comply with all applicable provisions of Government and local bodies' safety laws and building codes to prevent accidents, or injuries to persons or property of about or adjacent to his place of work. The contractor shall take insurance covers as per clause 24.0 at his own cost. The policy may be taken in joint names of the contractors and the SBI and the original policy may be lodged with the SBI.

### **13.0 Inspection of Work**

The SBI/Architect/Consultant or their representatives shall at all reasonable time have free access to the work site and/or to the workshop, factories or other places where materials are lying or from where they are obtained and the contractor shall give every facility to the SBI, Architect/Consultant and their representatives necessary for inspection and examination and test of the materials and workmanship. No person unless authorized by the SBI/Architect/Consultant except the representative of Public authorities shall be allowed on the work at any time. The proposed work either during its construction stage or its completion can also be inspected by the Chief Technical Examiner's organization a wing of Central Vigilance Commission.

### **14.0 Assignment and subletting**

The whole of work included in the contract shall be executed by the contractor and he shall not directly entrust and engage or indirectly transfer assign or underlet the contract or any part or share thereof or interest therein without the written consent of the SBI through the architect and no undertaken shall relieve the contractor from the responsibility of the contractor from active superintendence of the work during its progress.

### **15.0 Quality of Materials, Workmanship & Test**

(i) All materials and workmanship shall be best of the respective kinds described in the contract and in accordance with Architect/Consultant instructions and shall be subject from time to time to such tests as the architect/consultant may direct at the place of manufacture or fabrication or on the site or an approved testing laboratory. The contractor shall provide such assistance, instruments, machinery, labour and materials

#### **(ii) Samples**

All samples of adequate numbers, size, shades & pattern as per specifications shall be supplied by the contractor without any extra charges. If certain items proposed to be used are of such nature that samples cannot be presented or prepared at the site detailed literature/test certificate of the same shall be provided to the satisfaction of the Architect/consultant. Before submitting the sample/literature the contractor shall satisfy himself that the material/equipment for which he is submitting the samples/literature meet with the requirement of tender specification. Only when the samples are approved in writing by the architect/consultant the contractor shall proceed with the procurement and installation of the particular material/equipment. The approved samples shall be signed by the Architect/Consultant for identification and shall be kept on record at site office until the completion of the work for inspection/comparison at any time. The Architect/Consultant shall take reasonable time to approve the sample. Any delay that might occur in approving the samples for reasons of its not meeting the specifications or other discrepancies inadequacy in furnishing samples of best qualities from various manufacturers and such other aspects causing delay on the approval of the materials/equipments etc shall be to the account of the contractor.

#### **(iii) Cost of tests**

a) The cost of making any test shall be borne by the contractor if such test is intended by or provided for in the specifications or BOQ.

#### **(iv) Cost of test not provided for**

If any test is ordered by the Architect/ Consultant which is either:

(a) If so intended by or provided for or (in the cases above mentioned) is not so particularized or through so intended or provided for but ordered by the Architect/Consultant which is either to be carried out by an independent person at any place other than the site or the place of manufacture or fabrication of the materials tested or any Government/approved laboratory, then the cost of such test shall be borne by the contractor.

### **16.0 Obtaining Information related to execution of work**

No claim by the contractor for additional payment shall be entertained which is consequent upon failure on his part to obtain correct information as to any matter affecting the execution of the work nor any misunderstanding or the obtaining incorrect information or the failure to obtain correct information relieve him from any risks or from the entire responsibility for the fulfilment of contract.

### **17.0 Contractor's superintendence**

The contractor shall give necessary personal superintendence during the execution of the works and as long, thereafter, as the Architect/consultant may consider necessary until the expiry of the defects liability period, stated hereto.

### **18.0 Quantities**

i) The bill of quantities (BOQ) unless or otherwise stated shall be deemed to have been prepared in accordance with the Indian Standard Method of Measurements

The rate quoted shall remain valid for variation of quantity against individual item to any extent subject to maximum variation of the contract value by 25%. The entire amount paid under Clause 20 hereof as well as amounts of prime cost and provisional sums, if any, shall be excluded.

ii) Variation exceeding 25%: The items of work executed in relation to variation exceeding 25% shall be paid on the basis of provisions of clause 22(e) hereof.

### **19.0 Works to be measured**

The Architect/Consultant may from time to time intimate to the contractor that he required the work to be measured and the contractor shall forthwith attend or send a qualified representative to assist the Architect in taking such measurements and calculation and to furnish all particulars or to give all assistance required by any of them. Such measurements shall be taken in accordance with the Mode of measurements detailed in the specifications. The representative of the Architect/Consultant shall take joint measurements with the contractor's representative and the measurements shall be entered in the measurement book. The contractor or his authorized representative shall sign all the pages of the measurement book in which the measurements have been recorded in token of his acceptance. All the corrections shall be duly attested by both representatives. No over writings shall be made in the M book. Should the contractor not attend or neglect or omit to depute his representative to take measurements then the measurements recorded by the representative of the Architect/consultant shall be final. All authorized extra work, omissions and all variations made shall be included in such measurements.

### **20.0 Variations:**

No alteration, omission or variation ordered in writing by the Architect/Consultant shall vitiate the contract.

In case the SBI/Architect/Consultant thinks proper at any time during the progress of works to make any alteration in, or additions to or omission from the works or any alteration in the kind or quality of the materials to be used therein, the Architect/Consultant shall give notice thereof in writing to the contractor or shall confirm in writing within seven days of giving such oral instructions the contractor shall alter to, add to, or omit from as the case may be in accordance with such notice but the contractor shall not do any work extra to or make any alteration or additions to or omissions from the works or any deviation from any of the provisions of the contract, stipulations, specifications or contract drawings without previous consent in writing of the Architect/Consultant and the value of such extras, alterations, additions or omissions shall in all cases be determined by the Architect/Consultant and the same shall be added to or deducted from the contract value, as the case may be.

### **21.0 Valuation of Variations**

No claim for an extra shall be allowed unless it shall have been executed under the authority of the Architect/Consultant with the concurrence of the SBI as herein mentioned. Any such



extra is herein referred to as authorized extra and shall be made in accordance with the following provisions.

- a) i) The net rates or prices in the contract shall determine the valuation of the extra work where such extra work is of similar character and executed under similar conditions as the work priced herein.
- ii) Rates for all items, wherever possible should be derived out of the rates given in the priced BOQ.
- b) The net prices of the original tender shall determine the value of the items omitted, provided if omissions do not vary the conditions under which any remaining items of works are carried out, otherwise the prices for the same shall be valued under sub clause (c) hereunder.
- c) Where the extra works are not of similar character and/or executed under similar conditions as aforesaid or where the omissions vary the conditions under which any remaining items or works are carried out, then the contractor shall within 7 days of the receipt of the letter of acceptance inform the Architect/Consultant of the rate which he intends to charge for such items of work, duly supported by analysis of the rate or rates claimed and the Architect/Consultant shall fix such rate or prices as in the circumstances in his opinion are reasonable and proper, based on the market rate.
- d) Where extra work cannot be properly measured or valued the contractor shall be allowed day work prices at the net rates stated in the tender of the BOQ or, if not, so stated then in accordance with the local day work rates and wages for the district; provided that in either case, vouchers specifying the daily time (and if required by the Architect/Consultant) the workman's name and materials employed be delivered for verifications to the Architect/Consultant at or before the end of the week following that in which the work has been executed.
- e) It is further clarified that for all such authorized extra items where rates cannot be derived from the tender, the contractor shall submit rates duly supported by rate analysis worked on the "market rate basis" for material, labour, hire/running charges of equipment and wastages etc plus 15% towards establishment charges, contractor's overheads and profit. Such items shall not be eligible for escalation.

## **22.0 Final Measurement**

The measurement and valuation in respect of the contract shall be completed within 15 days of the virtual completion of the work.

## **23.0 Virtual Completion Certificate (VCC)**

On successful completion of entire works covered by the contract to the full satisfaction of the SBI, the contractor shall ensure that the following works have been completed to the satisfaction of the SBI.

- a) Clear the site of all scaffolding, wiring, pipes, surplus materials, contractor's labour, equipment and machinery.
- b) Demolish, dismantle and remove the contractor's site office, temporary works, structures including labour sheds/camps and constructions and other items and things whatsoever

brought upon or erected at the site or any land allotted to the contractor by the SBI and not incorporated in the permanent works.

- c) Remove all rubbish, debris etc from the site and the land allotted to the contractor by the SBI and shall clear, level and dress, compact the site as required by the SBI.
- d) Shall put the SBI in undisputed custody and possession of the site and all land allotted by the SBI.
- e) Shall hand over the work in a peaceful manner to the SBI.
- f) All defects/imperfections have been attended and rectified as pointed out by the SBI to the full satisfaction of SBI.

Upon the satisfactory fulfillment by the contractor as stated above, the contractor shall be entitled to apply to the Architect/Consultant for the certificate. If the Architect/Consultant is satisfied of the completion of the work, relative to which the completion certificate has been sought, the Architect/Consultant shall within fourteen (14) days of the receipt of the application for virtual completion certificate, issue a VCC in respect of the work for which the VCC has been applied.

This issuance of a VCC shall be without prejudice to the SBI's rights and contractor's liabilities under the contract including the contractor's liability for defects liability period nor shall the issuance of VCC in respect of the works or work at any site be construed as a waiver of any right or claim of the SBI against the contractor in respect of works or work at the site and in respect of which the VCC has been issued.

#### **24.0 Work by other agencies**

The SBI/Architect/Consultant reserves the rights to use premises and any portion of the site for execution of any work not included in the scope of this contract which it may desire to have carried out by other persons simultaneously and the contractor shall not only allow but also extend reasonable facilities for the execution of such work. The contractor however shall not be required to provide any plant or material for the execution of such work except by special arrangement with the SBI. Such work shall be carried out in such manners not to impede the progress of the works included in the contract.

#### **25.0 Insurance of Works**

25.1 Without limiting his obligations and responsibilities under the contract the contractor shall insure in the joint names of the SBI and the contractor against all loss or damages from whatever cause arising other than the excepted risks, for which he is responsible under the terms of contract and in such a manner that the SBI and contractor are covered for the period stipulated in clause 28 of GCC and are also covered during the period of maintenance for loss or damage arising from a cause, occurring prior to the commencement of the period of maintenance and for any loss or damage occasioned by the contractor in the course of any operations carried out by him for the purpose of complying with his obligations under clause.

- a) The works for the time being executed to the estimated current Contract value thereof, or such additional sum as may be specified together with the materials for incorporation in the works at their replacement value.
- b) The constructional plant and other things brought on to the site by the contractor to the replacement value of such constructional plant and other things.

c) Such insurance shall be effected with an insurer and in terms approved by the SBI which approval shall not be unreasonably withheld and the contractor shall whenever required produce to the Architect/Consultant the policy of insurance and the receipts for payment of the current premiums.

### **25.2 Damage to persons and property**

The contractor shall, except if and so far as the contract provides otherwise indemnify the SBI against all losses and claims in respect of injuries or damages to any person or material or physical damage to any property whatsoever which may arise out of or in consequence of the execution and maintenance of the works and against all claims proceedings, damages, costs, charges and expenses whatsoever in respect of or in relation thereto except any compensation of damages for or with respect to :

- a) The permanent use or occupation of land by or any part thereof.
- b) The right of SBI to execute the works or any part thereof, on, over, under, in or through any lands.
- c) Injuries or damages to persons or properties which are unavoidable result of the execution or maintenance of the works in accordance with the contract.
- d) Injuries or damage to persons or property resulting from any act or neglect of the SBI, their agents, employees or other contractors not being employed by the contractor or in respect of any claims, proceedings, damages, costs, charges and expenses in respect thereof or in relation thereto or where the injury or damage was contributed to by the contractor, his servants or agents such part of the compensation as may be just and equitable having regard to the extent of the responsibility of the SBI, their employees, or agents or other employees, or agents or other contractors for the damage or injury.

### **25.3 Contractor to indemnify SBI**

The contractor shall indemnify the SBI against all claims, proceedings, damages, costs, charges and expenses in respect of the matters referred to in the provision sub-clause 26.2 of this clause.

### **25.4 Contractor's superintendence**

The contractor shall fully indemnify and keep indemnified the SBI against any action, claim, or proceeding relating to infringement or use of any patent or design or any alleged patent or design rights and shall pay any royalties which may be payable in respect of any article or part thereof included in the contract. In the event of any claim made under or action brought against SBI in respect of such matters as aforesaid the contractor shall be immediately notified thereof and the contractor shall be at liberty, at his own expenses to settle any dispute or to conduct any litigation that may arise there from, provided that the contractor shall not be liable to indemnify the SBI if the infringement of the patent or design or any alleged patent or design right is the direct result of an order passed by the Architect/Consultant in this behalf.

### **25.5 Third Party Insurance**

Before commencing the execution of the work the contractor but without limiting his obligations and responsibilities under clause 26.0 of GCC shall insure against his liability for any material or physical damage, loss, or injury which may occur to any property including that of SBI, or to any person, including any employee of the SBI, by or arising out of the execution of the works

or in the carrying out of the contract, otherwise than due to the matters referred to in the provision to clause 26.0 thereof.

#### **25.5.2 Minimum Amount of Third Party Insurance**

Such insurance shall be effected with an insurer and in terms approved by the SBI which approval shall not be reasonably withheld and for at least the amount stated below. The contractor shall, whenever required, produce to the Architect/Consultant the policy or policies of insurance cover and receipts for payment of the current premiums.

25.6 The minimum insurance cover for physical property, injury, and death is Rs.5.0 lacs per occurrence with the number of occurrences limited to four. After each occurrence contractor will pay additional premium necessary to make insurance valid for four occurrences always.

#### **25.7 Accident or Injury to Workmen**

The SBI shall not be liable for or in respect of any damages or compensation payable at law in respect or in consequence of any accident or injury to any workmen or other person in the employment of the contractor or any sub-contractor, save and except an accident or injury resulting from any act or default of the SBI or their agents, or employees. The contractor shall indemnify and keep indemnified SBI against all such damages and compensation, save and except as aforesaid and against all claims, proceedings, costs, charges and expenses whatsoever in respect thereof or in relation thereto.

#### **25.7.2 Insurance against accidents etc to workmen**

The contractor shall insure against such liability with an insurer approved by the SBI during the whole of the time any person employed by him on the works and shall, when required, produce to the architect/consultant such policy of insurance and receipt for payment of the current premium. Provided always that, in respect of any persons employed by any sub-contractor the contractor's obligation to insure as aforesaid under this sub-clause shall be satisfied if the sub contractor shall have insured against the liability in respect of such persons in such manner that SBI is indemnified under the policy but the contractor shall require such sub-contractor to produce to the Architect/Consultant when required such policy of insurance and the receipt for the payment of the current premium.

#### **25.7.3 Remedy on Contractor's failure to insure**

If the contractor fails to effect and keep in force the insurance referred to above or any other insurance which he may be required to effect under the terms of contract, then and in any such case the SBI may effect and keep in force any such insurance and pay such premium or premiums as may be necessary for that purpose and from time to time deduct the amount so paid by the SBI as aforesaid and also deduct 15% of contract value from any amount due or which may become due to the contractor, or recover the same as debt from the contractor.

25.7.4 Without prejudice to the other rights of the SBI against contractors, in respect of such default, the Bank shall be entitled to deduct from any sums payable to the contractor the amount of any damages costs, charges, and other expenses paid by the SBI and which are payable by the contractors under this clause. The contractor shall upon settlement by the insurer of any claim made against the insurer pursuant to a policy taken under this clause, proceed with due diligence to rebuild or repair the works destroyed or damaged. In this event all the monies received from the insurer in respect of such damage shall be paid to the contractor and the contractor shall not be entitled to any further payment in respect of the expenditure incurred for rebuilding or repairing of the materials or goods destroyed or damaged.

### **26.0 Commencement of Works**

The date of commencement of the work will be reckoned as the recorded date of handing over site by the SBI or 15 days from the date of issue of Letter of Acceptance of Bank, whichever is later.

### **27.0 Time for completion**

Time is the essence of the contract and shall be strictly observed by the contractor. The entire work shall be completed within a period of **45 days** from the date of commencement. If required in the contract or as directed by the Architect/Consultant, the contractor shall complete certain portions of work before completion of the entire work. However the completion date shall be reckoned as the date by which the whole work is completed as per the terms of the contract.

### **28.0 Extension of Time**

If, in the opinion of the Architect/Consultant, the work be delayed for reasons beyond the control of the contractor, the Architect/Consultant may submit a recommendation to the SBI to grant a fair and reasonable extension of time for completion of work as per the terms of contract. If the contractor needs an extension of time for the completion of work or if the completion of work is likely to be delayed for any reasons beyond the due date of completion as stipulated in the contract, the contractor shall apply to the SBI through the Architect/Consultant in writing at least 30 days before the expiry of the scheduled time and while applying for extension of time he shall furnish the reasons in detail and his justification if any, for the delays. The architect/consultant shall submit their recommendations to the SBI in the prescribed format for granting extension of time. While granting extension of time the contractor shall be informed the period extended time which will qualify for levy of liquidated damages. For the balance period in excess of original stipulated period and duly sanctioned extension of time by the SBI the provision of liquidated damages as stated under clause 9 of GCC shall become applicable. Further contract shall remain in force even for the period beyond the due date of completion irrespective whether the extension is granted or not.

### **29.0 Rate of progress**

Whole of the materials, plant and labour to be provided by the contractor and the mode, manner and speed of execution and maintenance of the works are to be of a kind and conducted in a manner to the satisfaction of the Architect/Consultant. Should the rate of progress of the work or any part thereof be at any time be in the opinion of the Architect/ Consultant too slow to ensure the completion of the whole of the work by the prescribed time or extended time for completion the Architect/Consultant shall thereupon take such steps as considered necessary by the Architect/Consultant to expedite progress so as to complete the woks by the prescribed time or extended time. Such communications from the Architect/Consultant neither shall relieve the contractor from fulfilling obligations under the contract nor he shall be entitled to raise any claims arising out of such directions.

### **30.0 Work during nights and holidays**

Subject to any provision to the contrary contained in the contract no permanent work shall save as herein provided be carried on during the night or on holidays without the permission in writing of the Architect/Bank, save when the work is unavoidable or absolutely necessary for the saving of life or property or for the safety of the work in which case the contractor shall immediately advise the Architect/Bank. However the provision of the clause shall not be applicable in the case of any work which becomes essential to carry by rotary or double shifts in order to achieve the progress and quality of the part of the works being technically required and continued with the prior approval of the Architect/consultant at no extra cost to the SBI.

All work at night after obtaining approval from competent authorities shall be carried out without unreasonable noise and disturbance.

### **31.0 No compensation for restrictions of work**

If at any time after acceptance of the tender SBI shall decide to abandon or reduce the scope of work for any reason whatsoever and hence not require the whole or any part of the work to be carried out, the Architect/Consultant shall give notice in writing to that effect to the contractor and the contractor shall act accordingly in the matter. The contractor shall have no claim to any payment of compensation or otherwise whatsoever, on account of any profit or advantage which he might have derived from the execution of the work fully but which he did not derive in consequence of the foreclosure of the whole or part of the work. Provided that the contractor shall be paid the charges on the cartage only of materials actually and bona fide brought to the site of the work by the contractor and rendered surplus as a result of the abandonment, curtailment of the work or any portion thereof and then taken back by the contractor, provided however that the Architect/Consultant shall have in such cases the option of taking over all or any such materials at their purchase price or a local current rate whichever is less.

In case of such stores having been issued from SBI stores and returned by the contractor to stores, credit shall be given to him at the rates not exceeding those at which were originally issued to the contractor after taking into consideration and deduction for claims on account of any deterioration or damage while in the custody of the contractor and in this respect the decision of Architect/Consultant shall be final.

### **32.0 Suspension of work**

i) The contractor shall, on receipt of the order in writing of the Architect/Consultant (whose decision shall be final and binding on the contractor) suspend the progress of works or any part thereof for such time and in such manner as Architect/Consultant may consider necessary so as not cause any damage or injury to the work already done or endanger the safety thereof for any of following reasons.

- a) On account any default on the part of the contractor, or
- b) For proper execution of the works or part thereof for reasons other than the default of the contractor, or
- c) For safety of the works or part thereof. The contractor shall, during such suspension, properly protect and secure the works to the extent necessary and carry out the instructions given in that behalf by the Architect/Consultant.

ii) If the suspension is ordered for reasons (b) and (c) in sub-Para (i) above : The contractor shall be entitled to an extension of time equal to the period of every such suspension. No compensation whatsoever shall be paid on this account.

### **33.0 Action when the whole security deposit is forfeited**

In any case in which under any clause or clauses of this contract, the Contractor shall have rendered himself liable to pay compensation amounting to the whole of his security deposit the Architect/Consultant shall have the power to adopt any of the following course as they may deem best suited to the interest of the SBI.

- a) To rescind the contract (of which rescission notice in writing to the contractor by the Architect/Consultant shall be conclusive evidence) and in which case the security deposit of the contractor shall be forfeited and be absolutely at the disposal of SBI.

b) To employ labour paid by the SBI and to supply materials to carry out the work, or any part of the work, debiting the contractor with the cost of the labour and materials (the cost of such labour and materials as worked out by the Architect/ Consultant shall be final and conclusive against the contractor) and crediting him with the value

of the work done, in all respects in the same manner and at the same manner and at the same rates as if it had been carried out by the contractor under the terms of this contract the certificate of Architect/Consultant as to the value of work done shall be final and conclusive against the contractor.

c) To measure up the work of the contractor, and to take such part thereof as shall be unexecuted, out of his hands, and to give it to another contractor to complete in which case any expenses which may be incurred in excess of the sum which would have been paid to the original contractor, if the whole work had been executed by him (of the amount of which excess the certificates in writing of the Architects/ Consultant shall be final and conclusive) shall be borne by original contractor and may be deducted from any money due to him by SBI under the contract or otherwise, or from his security deposit or the proceeds of sale thereof, or sufficient part thereof.

In the event of any of above courses being adopted by the SBI the contractor shall have no claim to compensation for any loss sustained by him by reasons of his having purchased or procured any material or entered into any engagements or make any advances on account of, or with a view to the execution of the work or the performance of the contract and in case the contract shall be rescinded under the provision aforesaid, the contractor shall not be entitled to recover or to be paid any sum or any work thereto for actually performed under this contract, unless, and until the Architect/Consultant will have certified in writing the performance of such work and the value payable in respect thereof, and he shall only be entitled to be paid the value so certified.

#### **34.0 Owner's Right to Terminate the Contract**

If the contractor being an individual or a firm commit any 'Act of Insolvency' or shall be adjusted an insolvent or being an incorporated company shall have an order for compulsory winding up voluntarily or subject to the supervision of Government and of the Official Assignee of the liquidator in such acts of insolvency or winding up shall be unable within seven days after notice to him to do so, to show to the reasonable satisfaction of the Architect/Consultant that he is able to carry out and fulfill the contract, and to give security therefore if so required by the Architect/Consultant.

Or if the contractor (whether an individual firm or incorporated Company) shall suffer execution to be issued or shall suffer any payment under this contract to be attached by or on behalf of any of the creditors of the contractor.

Or shall assign or sublet this contract without the consent in writing of the SBI through the Architect/Consultant or shall charge or encumber this contract or any payment due to which may become due to the contractor there under.

- a) Has abandoned the contract; or
- b) Has failed to commence the works, or has without any lawful excuse under these conditions suspended the progress of the works for 14 days after receiving from the SBI through the Architect/Consultant written notice to proceed, or
- c) Has failed to proceed with the works with such diligence and failed to make such due progress as would enable the works to be completed within the time agreed upon, or has

failed to remove the materials from the site or to pull down and replace work within seven days after written notice from the SBI through the Architect/ Consultant that the said materials were condemned and rejected by the Architect/ Consultant under these conditions; or has neglected or failed persistently to observe and perform all or any of the acts, matters or things by this contract to be observed and performed by the contractor for seven days after written notice shall have been given to the contractor to observe or perform the same or has to the detriment of good workmanship or in defiance of the SBI's or Architect's/Consultant's instructions to the contrary subject any part of the contract. Then and in any of said cases the SBI and or the Architect/Consultant, may not withstanding any previous waiver, after giving seven days notice in writing to the contractor, determine the contract, but without thereby affecting the powers of the SBI or the Architect/Consultant or the obligation and liabilities of the contractor the whole of which shall continue in force as fully as if the contract had not been so determined and as if the works subsequently had been executed by or on behalf of the contractor. And, further the SBI through the Architect/Consultant, their agents or employees may enter upon and take possession of the work and all plants, tools, scaffoldings, materials, sheds, machineries lying upon the premises or on the adjoining lands or roads, use the same by means of their own employees or workmen in carrying on and completing the work or by engaging any other contractors or persons to complete the work and the contractor shall not in any way interrupt or do any act, matter or thing to prevent or hinder such other contractor or other persons employed for completing and finishing or using the materials and plant for the works.

When the works shall be completed or as soon thereafter as convenient the SBI or the Architect/Consultant shall give a notice in writing to the contractor to remove his surplus materials and plants and should the contractor fail to do so within 14 days after receipt thereof by him the SBI sell the same by public auction after due publication and shall adjust the amount realized by such auction. The contractor shall have no right to question any of the act of the SBI incidental to the sale of the materials etc.

### **35.0 Certificate of Payment**

The contractor shall be entitled under the certificates to be issued by the SBI/ Architect/ Consultant to the contractor within 7 working days from the date of certificate to the payment from SBI from time to time. The payments will be released based on the work done and 1<sup>st</sup> running payment will be released only after more than 50% of the works is complete as per the certificate issued by the SBI/ Architect/ Consultant. 2<sup>nd</sup> running payment will be released only after 75% work is complete. 3<sup>rd</sup> running payment will be released in exceptional circumstances only after the works are virtually complete. In any case, no more than 3 running payments will be made.

The SBI shall recover the statutory recoveries and other dues including the retention amount from the final certificate of payment.

Provided always that the issue of any certificate by the SBI/Architect/Consultant during the progress of works or completion shall not have effect as certificate of satisfaction or relieve the contractor from his liability under clause.

The SBI/Architect/Consultant shall have power to withhold the certificate if the work or any part thereof is not carried out to their satisfaction.



The SBI/Architect/Consultant may by any certificate make any corrections required in previous certificate.

The SBI can modify the certificate of payment as issued by the SBI/Architect/Consultant from time to time while making the payment. The contractor shall submit bills only after taking actual measurements and properly recorded in the Measurement book / sheets. The contractor shall not submit interim bills when the approximate value of work done by him is less than **50% of contract value** and the minimum interval between two such bills shall be seven days.

The final bill may be submitted by contractor within a period of 30 days from the date of virtual completion and SBI/Architect/Consultant shall issue the certificate of payment within a period of one month. The SBI shall pay the amount within a period of 7 days from the date of issue of final certificate.

### **36.0 Settlement of Disputes and Arbitration**

Except where otherwise provided in the contract all questions and disputes relating to the meaning of the specifications, design, drawings and instructions herein before mentioned and as to the quality of workmanship or materials used on the work or as to any other question, claim, right, matter or thing whatsoever in any way arising out of or relating to the contract, designs, drawings, specifications, estimates, instructions, orders or these conditions or otherwise concerning the work or the execution or failure to execute the same, whether arising during the progress of the work or after the cancellation, termination, completion or abandonment thereof shall be dealt with as mentioned hereinafter :

- i) If the contractor considers that he is entitled to any extra payment or compensation in respect of the works over and above the amounts admitted as payable by the Architect or in case the contractor wants to dispute the validity of any deductions or recoveries made or proposed to be made from the contract or raise any dispute, the Contractor shall forthwith give notice in writing of his claim, or dispute to the Regional Manager and endorse a copy of the same to the Architect, within 30 days from the date of disallowance thereof or the date of deduction or recovery. The said notice shall give full particulars of the claim, grounds on which it is based and detailed calculations of the amount claimed and the contractor shall not be entitled to raise any claim nor shall the Bank be in any way liable in respect of any claim by the contractor unless notice of such claim shall have been given by the contractor to the Regional Manager in the manner and within the time as aforesaid. The contractor shall be deemed to have waived and extinguished all his rights in respect of any claim not notified to Regional Manager in writing in the manner and within the time aforesaid.
- ii) The Regional Manager shall give his decision in writing on the claims notified by the contractor. The contractor may within 30 days of the receipt of the decision of the Regional Manager submit his claims to the conciliating authority namely the Dy. General Manager (B&O) for conciliation along with all details and copies of correspondence exchanged between him and the Regional Manager.
- iii) If the conciliation proceedings are terminated without settlement of the disputes, the contractor shall, within a period of 30 days of termination thereof shall give a notice to the concerned Regional Business Office-I (RBO-I), First Floor, Bhagu Road Bathinda of the Bank for appointment of an arbitrator to adjudicate the notified claims failing which the claims of the contractor shall be deemed to have been considered absolutely barred and waived.

- iv) Except where the decision has become final, binding and conclusive in terms of the contract, all disputes or differences arising out of the notified claims of the contractor as aforesaid and all claims of the Bank shall be referred for adjudication through arbitration by the Sole Arbitrator appointed by the Dy. General Manager (B&O). It will also be no objection to any such appointment that the Arbitrator so appointed is a Bank Officer and that he had to deal with the matters to which the Contract relates in the course of his duties as Bank Officer. If the arbitrator so appointed is unable or unwilling to act or resigns his appointment or vacates his office due to any reason whatsoever another sole arbitrator shall be appointed in the manner aforesaid by the said Dy. General Manager (B&O). Such person shall be entitled to proceed with the reference from the stage at which it was left by his predecessor.

It is a term of this contract that the party invoking arbitration shall give a list of disputes with amounts claimed in respect of each dispute along with the notice for appointment of arbitrator.

It is also a term of this contract that no person other than a person appointed by such Regional Business Office-I, First Floor, Bhagu Road Bathinda . aforesaid should act as arbitrator.

The conciliation and arbitration shall be conducted in accordance with the provisions of the Arbitration & Conciliation Act 1996 or any statutory modification or re-enactment thereof and the rules made there under.

It is also a term of the contract that if any fees are payable to the arbitrator these shall be paid equally by both the parties. However, no fees will be payable to the arbitrator if he is a Bank Officer.

It is also a term of the contract that the arbitrator shall be deemed to have entered on the reference on the date he issues notice to both the parties calling them to submit their statement of claims and counter statement of claims. The venue of the arbitration shall be such place as may be fixed by the arbitrator in his sole discretion. The fees if any, of the arbitrator shall, if required to be paid before the award is made and published, be paid half and half by each of the parties. The cost of the reference and of the award (including the fees, if any of the arbitrator) shall be in the discretion of the arbitrator who may direct to any by whom and in what manner, such costs or any part thereof shall be paid and fix or settle the amount of costs to be so paid.

### **37.0 Water supply**

The contractor shall make his own arrangements for water required for the work and nothing extra will be paid for the same. This will be subject to the following conditions:

- i) That the water used by the Contractor shall be fit for construction purpose to the satisfaction of the Architect/Consultant.
- ii) The Contractor shall make alternative arrangements for the supply of water, if the arrangements made by the Contractor for procurement of water, in the opinion of the Architect/Consultant, is unsatisfactory.

37.1 The Contractor shall construct temporary well/tube well in SBI land for taking water for construction purposes only after obtaining permission in writing from the SBI. The contractor has to make his own arrangements for drawing and distributing the water at his own cost. He has to make necessary arrangements. To avoid any accidents or damages caused due to construction and subsequent maintenance of the wells. He has to obtain necessary approvals from the local authorities, if required. at his own cost. He shall restore the ground to its original

condition after wells are dismantled on completion of work or hand over the well to the SBI without any compensation as directed by the Architect/Consultant.

### **38.0 Power supply**

The contractor shall make his own arrangements for power and supply/distribution system for driving plant or machinery for the work and for lighting purpose at his own cost. The cost of running and maintenance of the plants are to be included in his tender prices. He shall pay all fees and charges required for the power supply and include the same in his tendered rates and hold the owner free from all such costs. He has to obtain necessary approvals from the appropriate authorities, if required.

### **39.0 Treasure Trove etc.**

Any treasure trove, coin or object antique which may be found on the site shall be the property of SBI and shall be handed over to the Bank immediately.

### **40.0 Method of Measurement**

Unless otherwise mentioned in the schedule of quantities or in mode of measurement, the measurement will be on the net quantities or work produced in accordance with up to date. Rules laid down by the Bureau of Indian Standards. In the event any dispute/disagreement the decision of the Architect/Bank shall be final and binding on the contractor.

### **41.0 Maintenance of Registers**

The contractor shall maintain the following registers as per the enclosed format at site of work and should produce the same for inspection of SBI/Architect/Consultant whenever desired by them. The contractor shall also maintain the records/registers as required by the local authorities/Government from time to time.

- i) Register for secured advance
- ii) Register for hindrance to work
- iii) Register for running account bill
- iv) Register for labour

### **Clause 42.0**

#### **PRICE VARIATION ADJUSTMENT (PVA) FOR ALL MATERIALS & LABOUR**

#### **(Application only for completion period beyond 12 months)**

In partial modification on the provisions made elsewhere in this contract regarding rate quoted being not subject to any variations, price adjustment to the value of work payable to the Contractor at tendered rates shall be made toward variations in the prices of materials and labour in the manner specified hereunder:-

If after written order to commence the work and during the operative period of this contract including any authorized extensions of the original stipulated completion period:-

- (a) There be any variation in the Consumer Price Index – General Index- for industrial workers (Base 1982=100) (source – data published form time to time Indian Lanour Journal by the Labour Bureau, Government of India):

OR

(b) There be any variation in the All Indian Wholesale Price Index for all commodities (Base 1993-94=100) (as published from time to time in the RBI Bulletin based on the date issued by the Officer of the Economic Advisor to the Government of India):

Price Variation Adjustment (PVA) towards (1) Labour Component and (2) Material Component shall be calculated in accordance with the formula A and B respectively, given below, subject to stipulations herein under mentioned:-

**FORMULA (A) FOR LABOUR:**

$$CL = 0.85P \times \frac{K1 \times (C1 - C0)}{100C0}$$

**FORMULA (B) FOR MATERIALS:**

$$VM = 0.85X \frac{(P - Y) \times K2 \times (I1 - I0)}{100 I0}$$

Where-

VL = Amount of price Variation Adjustment  
Increase or decrease in rupee due to labour component

VM = Amount of price Variation Adjustment  
Increase or decrease in rupee account of materials component

NOTE: Bill period (noted hereunder) signifies the period of actual execution  
And not date of measurement or preparation of bill.

P = Cost of work done during the period under consideration (bill period)  
Excluding advance on material and/or adjustments there of.

Y = Cost of any other material supplied/ arranged by the Bank at fixed  
Price during the period under consideration (bill period)

K1 = Percentage of labour component calculated as indicated in note (1) below

K2 = Percentage of material component as indicated in note (2) below

CO = Consumer Price Index – General index Number for industrial workers (Base 1982 = 100) referred to at

(a) above, ruling on the last due date of receipt of tender, and as application to the centre, nearest to the place of work, for which the which the index is published)

C1 = Average of above mentioned Consumer Price Index number during the period under consideration (bill period)

I0 = All India Wholesale Price Index number for all commodities referred to at (b) above. Ruling on the last date for Receipt of tenders and as application to the center, nearest to the place of work for which the index is published.

I1 = Average of above mentioned monthly all India Wholesale Price Index number during the period under Consideration (bill period)

NOTE (1) : K1 shall be taken as under:-

Component of work K1

- |  |    |
|--|----|
| a) Electrical installation works including fitting and fixtures<br>(external & internal work only) | 20 |
|--|----|

NOTE (2) : K2 shall be taken as under:-

Component of work K2

80

- |   |    |
|---|----|
| a) Electrical installation works including fitting and fixtures<br>as detailed under Note (1) (a) above | 80 |
|---|----|

**Stipulation:**

- (i) PVA clause is operative either way i.e. if the variations in above referred price indices are on the plus side. PVA shall be payable to the contractor and if they are on the negative side PVA shall be recoverable from the contractor for the respective bill period of occurrence of fluctuations.
- (ii) The rates quoted by the Contractor shall be treated as firm for the value of work required to be done in the first 12 months of the contract period from the date of written order to commence work and no PVA is admissible on the same on any grounds whatsoever. The value of work required to be done during the first 12 months of the contract period shall be taken as 80% of the value of work to be done on pro-rate basis in 12 months as compared to the total stipulated completion period. No PVA is admissible on the value of work required to be done in first 12 months as worked out above, even if this value of work is actually done in a period longer than 12 months. However, in case if any delay in the first 12 months due to genuine reasons which are not attributable to the contractor and which are beyond his control, such period of delay will be deducted from 12 months, and the value of work to be done will be 80% of the pro-rate value of work to be done in such reduced period on pro-rate basis.

- (iii) a) For works where the original stipulated period of completion is not more than 12 months, no PVA whatsoever is permissible under this clause. However, if the period of completion is delayed beyond 12 months on account of genuine reasons which are not attributable to the contractor and which are beyond his control, PVA will be admissible on the value of work done only in excess of value of work required to be done on a prorata basis in the first 12 months minus the period of such genuine delay.
- b) For purpose of admissibility of PVA all the cumulative period of extensions granted for reasons which are solely attributable to the contractor is excluded from the total extended period of the contracts and PVA shall not be admissible on the value of work done during such period of extensions, which are granted for keeping the contract current.
- c) Notwithstanding anything to the contrary mentioned in any other clause/clauses of the contract, extensions of the contract period shall be granted by the Architect only with prior approval of the Bank. Extensions granted by the Architect without Bank's prior approval shall not bind the Bank for payment of PVA for work done in the concerned period of extensions.
- (iv) a) Where the total cost of work done beyond the value of work required to be done in the first 12 months (vide note (ii) and (iii) above) does not exceed Rs.50 lacs the total amount of PVA worked out on the basis of provisions of foregoing stipulations will be limited to an upper ceiling of 10% of such value of work done in excess of value of work required to be done in the first 12 months, minus the cost of any materials issued/arranged by the Bank at fixed prices i.e. P-Y (these terms being as per definitions given formulae A and B above).
- b) Where the total value of work done beyond the value of work required to be done in the first 12 months exceeds Rs.50 lacs, the PVA on the first Rs.50 lacs will be calculated as provided for in the foregoing para and for the balance value of work done for which PVA is admissible subject to foregoing conditions, the PVA will have the upper ceiling of 10% but it will be worked out at a lower rate i.e. 80% of the amount worked out as per the formulae A and B referred to earlier.
- (v) In working out the amount of PVA as per all the foregoing stipulations, value of such extra items or such portions of extra items the rates of which are derived from the prevailing market rates of materials and labour will not be included in the value of work done. Value of only such extra items or such portions of extra items, rates of which are derived entirely from tendered rates will be included in the value of work on which PVA as calculated.
- (vi) For claiming the payment for PVA the contractor shall keep such books of accounts and other documents, vouchers receipts etc. as may be required by the Bank/Architect, for verification of the increased claims or reduction to be made as the case may be and he shall also allow Engineers and/or other duly authorized representatives of the Bank/Architects and furnish such information as may be required or called for the enable verification of the claim within a week of such request.
- (vii) The contractor is required to submit to Bank, through the Architect, his claims for PVA separately for each running Bill for the individual bill periods for the work paid to him by the Bank. He will also be required to submit detailed calculations in support of the claims.

(viii) No claim will be entertained from the contractor for interest or any other grounds for non-payment or for any delay in payment of PVA due to late publication or non-availability of the necessary price indices or due to delay in preparation of the running of final bills

(ix) In view of adjustments for variations in process of materials and labour which have been covered in this clause no other adjustments for any reason whatsoever like statutory measures, taxes, levies, etc will be allowed.

### **43.0 Force Majeure**

43.1 Neither contractor nor SBI shall be considered in default in performance of their obligations if such performance is prevented or delayed by events such as war, hostilities, revolution, riots, civil commotion, strikes, lockout, conflagrations, epidemics, accidents, fire, storms, floods, droughts, earthquakes or ordinances or any act of god or for any other cause beyond the reasonable control of the party affected or prevented or delayed. However a notice is required to be given within 30 days from the happening of the event with complete details, to the other party to the contract, if it is not possible to serve a notice, within the shortest possible period without delay.

43.2 As soon as the cause of force majeure has been removed the party whose ability to perform its obligations has been affected, shall notify the other of such cessation and the actual delay incurred in such affected activity adducing necessary evidence in support thereof.

43.3 From the date of occurrence of a case of force majeure obligations of the party affected shall be suspended during the continuance of any inability so caused. With the cause itself and inability resulting therefrom having been removed, the agreed time of completion of the respective obligations under this agreement shall stand extended by a period equal to the period of delay occasioned by such events.

43.4 Should one or both parties be prevented from fulfilling the contractual obligations by a state of force majeure lasting to a period of 6 months or more the two parties shall mutually decide regarding the future execution of this agreement.

### **44.0 Local Laws, Acts, Regulations**

The contractor shall strictly adhere to all prevailing labour laws inclusive of contract labour (regulation and abolition act of 1970) and other safety regulations. The contractor shall comply with the provision of all labour legislation including the latest requirements of all the Acts, laws, any other regulations that are applicable to the execution of the project.

- i) Minimum Wages Act, 1948 (Amended)
- ii) Payment of Wages Act 1936 (Amended)
- iii) Workmen's Compensation Act 1923 (Amended)
- iv) Contract Labour Regulation and Abolition Act 1970 and Central Rules 1971 (Amended)
- v) Apprentice Act 1961 (Amended)
- vi) Industrial Employment (Standing Order) Act 1946 (Amended)
- vii) Personal Injuries (Compensation Insurance) Act 1963 and any other modifications
- viii) Employees' Provident Fund and Miscellaneous Provisions Act 1952 and

amendment thereof

ix) Shop and Establishment Act

x) Any other Act or enactment relating thereto and rules framed thereunder from time

to time.

**45.0 SAFETY CODE:  
SAFETY MEASURES AT SITE:**

1. All personnel at site should be provided with Helmets and Safety Boots with some Identification Mark. Visitors also should be provided with Helmets. It should be ensured that these are used properly.
2. First Aid Box should be kept at site with all requisite materials.
3. No one should be allowed to inspect / work at a height without Safety Belt.
4. Suitable scaffolds should be provided for workmen for all Works that cannot safely be done from the ground, or from solid construction except such short period Work as can be done safely from ladders. When a ladder is used an extra Mazdoor shall be engaged for holding the ladder and if the ladder is used for carrying materials as well as suitable footholds and handholds shall be provided on the ladder and the ladder shall be given an inclination not steeper than  $\frac{1}{4}$  to 1 ( $\frac{1}{4}$  horizontal and 1 vertical).
5. Scaffolding or staging more than 3.5 meters above the ground or floors, swung or suspended from an overhead support or erected with stationary support shall have a guard rail properly attached, bolted, braced and otherwise secured at least 1 Meter high above the floor or platform of such scaffolding or staging and extending along the entire length of the outside and ends thereof with only such openings as may be necessary for the delivery of materials. Such scaffolding or staging shall be so fastened as to prevent it from swaying from the building or structure.
6. Working platforms, Gangways, and Stairways should be so constructed that they do not sag unduly or unequally, and if the height of the platform or the Gangway or the Stairway is more than 3-5 Meters above ground level or floor level they should be closely boarded, should have adequate width and should be suitably fenced, as described.
7. Every opening in the floor of a building or in a working platform be provided with suitable means to prevent the fall of persons or materials by providing suitable fencing or railing whose minimum height shall be 1 Meter.
8. Safe means of access shall be provided to all working platforms and other working places. Every ladder shall be securely fixed. No portable single ladder shall be over 9 Meters in length while the width between side rails in rung ladder shall in no case be less than 30cms for ladder upto and including Meters in length. For longer ladders this width should be increased at least 6mm for each additional 30 cms. Uniform step spacing shall not exceed 30 cms.
9. Adequate precautions shall be taken to prevent danger from electrical equipments. For electrical on line works gloves, rubber mats, and rubber shoes shall be used.
10. All trenches 1.2 Meters or more in depth shall at all times be supplied with at least one ladder for each 30 Meters length or fraction thereof. Ladder shall be extended from bottom of the trench to at least 1 Meter above the surface of the ground. The sides of the trenches, which are 1.5 Meters or more in depth shall be stepped back to give suitable slope, or securely held by timber bracing, so as to avoid the danger of sides collapsing. The excavated materials shall not be placed within 1.5 Meters of the edge of the trench or half of the depth of



the trench whichever is more cuttings shall be done from top to bottom. Under no circumstances undermining or under cutting shall be done.

11. Before any demolition work is commenced and also during the process of the work :-

a) All roads and open areas adjacent to the Work Site shall either be closed or suitably protected;

b) No electrical cable or apparatus which is liable to be a source of danger over a cable or apparatus used by the operator shall remain electrically charged.

c) All practical steps shall be taken to prevent danger to persons employed from risk of fire or explosion or flooding. No floor, roof or other part of the building shall be so over-loaded with debris or materials as to render it unsafe.

d) All necessary personal safety equipment as considered adequate by the Site Engineer should be kept available for the use of the persons employed on the Site and maintained in a condition suitable for immediate use; and the Contractor should take adequate steps to ensure proper use of equipment by those concerned.

e) Workers employed on mixing Asphaltic materials, cement and lime mortars shall be provided with protective footwear and protective goggles.

f) Those engaged in white washing and mixing or stacking of cement bags or any materials which are injurious to the eyes shall be provided with protective goggles.

g) Those engaged in welding works shall be provided with Welder's protective eye-shields.

h) Stone breakers shall be provided with protective goggles and protective clothing and seated at sufficiently safe intervals.

i) When workers are employed in sewers and manholes, which are in use, the Contractor shall ensure that the manhole covers are opened and are ventilated at least for an hour before the workers are allowed to get into the manholes and the manholes so opened shall be cordoned off with suitable railing and provided with warning signals and boards to prevent accident to the Public.

12. Use of hoisting machines and tackle including their attachments, anchorage and support shall conform to the following standard or conditions:-

a) These shall be of good mechanical construction, sound material and adequate strength and free from patent defect and shall be kept in good repairs and in good working order.

b) Every rope used in hoisting or lowering materials or as a means of suspension shall be of durable quality and adequate strength, and free from patent defects.

c) Every crane driver or hoisting appliance operator shall be properly qualified and no person under the age of 21 years should be in-charge of any hoisting machine including any scaffold, winch or give signals to the operator.

d) In case of every hoisting machine and of every chain ring hook, shackle swivel and pulley block used in hoisting or lowering or as means of suspension the safe working load shall be ascertained by adequate means.

e) Every hoisting machine and all gear referred to above shall be plainly marked with the safe working load. In case of hoisting machine having a variable safe working load, each safe working load of the conditions under which it is applicable shall be clearly indicated. No part of any machine or of any gear referred to above in this paragraph shall be loaded beyond the safe working load except for the purpose of testing.

f) Motor, Gearing, Transmission, Electric wiring and other dangerous parts of hoisting appliances should be provided with efficient safeguards, hoisting appliances should be provided with such means as will reduce to the minimum the risk of accidental descent of the load, adequate precautions should be taken to reduce to the minimum the risk of any part of a suspended load becoming accidentally displaced.

g) When workers are employed on electrical installation, which are already energized, insulating mats, wearing apparel such as gloves, sleeves, and boots as may be necessary should be provided. The workers should not wear any rings, watches and carry keys or other materials, which are good conductors of electricity.

13. All scaffolds, ladders and other safety devices, mentioned or described herein shall be maintained in safe condition and no scaffold, ladder or equipment shall be altered or removed while it is in use. Adequate washing facilities shall be provided at or near places of work.

**46.0 Accidents**

The contractor shall immediately on occurrence of any accident at or about the site or in connection with the execution of the work report such accident to the Architect/Consultant. The contractor shall also report immediately to the competent authority whenever such report is required to be lodged by the law and take appropriate actions thereof.

**47.0 BANK’S BUILDING CONSTRUCTION PROJECTS – MAINTENANCE OF RECORDS**

<b>A.</b>	<b>Registers at the site office of the Bank’s Engineer:</b>
<b>1</b>	Measurement Books.
<b>2</b>	Cement Register (Daily Record).
<b>3</b>	Steel Register.
<b>4</b>	Steel Consumption Register – Bill wise.
<b>5</b>	Drawing register.
<b>6</b>	Materials at site register.
<b>7</b>	Hindrance Register.
<b>8</b>	Concrete cube Test Register.
<b>9</b>	File and Register for extra / variation items.
<b>10</b>	Materials test Register and File.
<b>11</b>	Site Order Book (in triplicate)
<b>12</b>	Lead caulking Register.
<b>13</b>	Labour Report and progress Report Register.
<b>14</b>	Site Visit & Instructions Register.
<b>15</b>	Certified true copies of the contracts.

**GENERAL MATERIAL MAKES**

(For Electrical/ Networking Tenders)

<i>Sr.</i>	<i>Name of Various Items</i>	<i>Makes</i>
(A)	<i>Electrical Wiring /Cabling/Earthing</i>	
1	<i>Wires</i>	<i>Finolex/Polycab/Havells</i>
2	<i>Copper/Aluminium Power Cables</i>	<i>Ecko/Havells/Polycab/Pymen/Finolex</i>
3	<i>Telephone Cables</i>	<i>Delton/Finolex/Polycab</i>
4	<i>PVC Conduit</i>	<i>ISI Marked</i>
5	<i>MS Conduit</i>	<i>Anchor/North West ISI Marked</i>
6	<i>GI Pipe</i>	<i>ISI Marked</i>
7	<i>Switches/Sockets (Modular)</i>	<i>Anchor/Crabtree/North-West/MK</i>
8	<i>Raceways</i>	<i>MK /North-West</i>
9	<i>Data cabling- Cat 5</i>	<i>Lucent/HCL/IBM/AMP/Krone/D-Link/Molex</i>
10	<i>Information Outlets</i>	<i>Lucent/HCL/IBM/AMP/Krone/D-Link/Molex/Legrand</i>
11	<i>Jack panel</i>	<i>Lucent/HCL/IBM/AMP/Krone/D-Link/Molex/Digilink/Legrand</i>
12	<i>Network Switches</i>	<i>3 COM/INTEL/COMPAX/SMC/D-Link/Lanbit/Digilink/Legrand</i>
(B)	<i>Main Panel/Distribution Board/Switches etc.</i>	
1	<i>ELCB/RCCB</i>	<i>Indoasian/Hager/Legrand/L&amp;T</i>
2	<i>MCB and Distribution boards, Metal Clad sockets and MCBs</i>	<i>Indoasian/Havells/HPL/Standard/Hager/Legrand/L&amp;T</i>
3	<i>MCCBs</i>	<i>L&amp;T/ABB/GE</i>
4	<i>Switch Fuse Unit/ Fuse Switch Unit</i>	<i>L&amp;T/C&amp;S/GE</i>
5	<i>Rewireable Switches</i>	<i>Havells/Standard/HPL</i>
6	<i>Change Over Switches</i>	<i>Havells/Standard/HPL/C&amp;S</i>
7	<i>Kit Kats</i>	<i>Havells/Standard/GECO</i>
8	<i>Ammeter/Voltmeter</i>	<i>Automatic Electric/Rishab/Essma</i>
9	<i>Selector Switch</i>	<i>L&amp;T/Kay Cee/HPL</i>
10	<i>C/Ts</i>	<i>Automatic Electric/Rishab/Essma</i>
11	<i>Led indicators</i>	<i>L&amp;T/C&amp;S</i>
12	<i>Cable Glands</i>	<i>HMI/BBI/Commet</i>

13	<i>Lugs/Ferrules</i>	<i>Esscon/Jainson</i>
14	<i>Capacitors/for PF improvement</i>	<i>Asian/Epcos</i>
(C)	<i>ELECTRICAL FIXTURES</i>	
1	<i>Light Fittings</i> <i>i. 2`X2` Light Fittings With LED</i> <i>ii. 4` Light Fitting with T 5 Lamps</i> <i>iii Downlighter - LED</i>	<i>Philips/Bajaj/Wipro/ Crompton</i> <i>Philips//Bajaj/Wipro/ Crompton</i> <i>Philips//Bajaj/Wipro/ Crompton</i>
2	<i>Ceiling Fans</i> <i>i. General Purpose</i> <i>ii. Energy Efficient Ceiling Fans</i>	<i>Crompton/Usha/Bajaj</i>
3	<i>Wall Fans</i>	<i>Havells/Crompton/Bajaj</i>

Signature & Seal of the Contractor

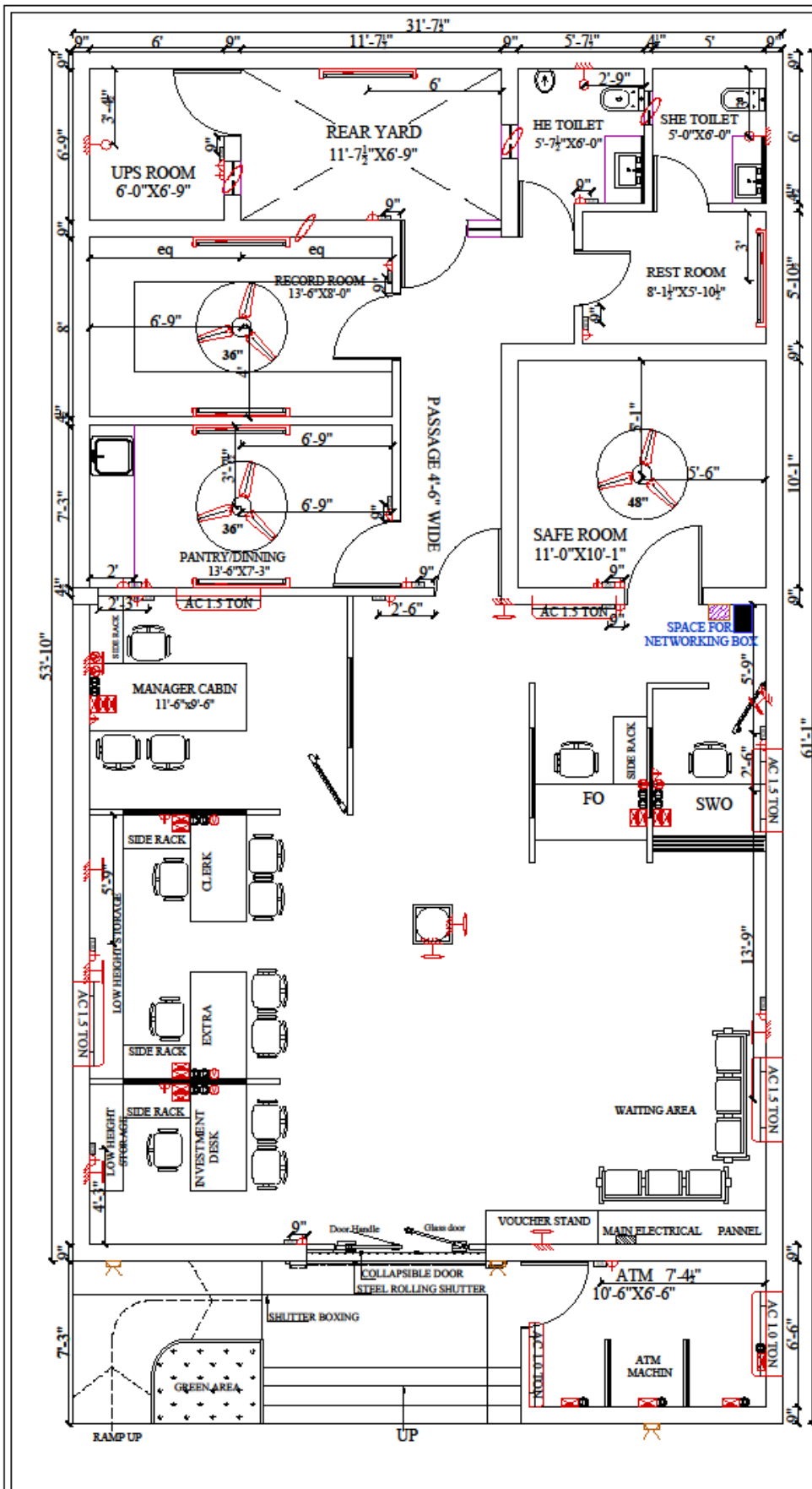

ELECTRICAL WORK		
SYMBOL	ITEM NAME	MOUNTED H.T FROM F.F.L
	SWITCH BOARD	3'-0"
	CEILING FAN	—
	4 FEET TUBE LIGHT	9'-0"
	16 AMP SOCKET FOR WORKSTATION	—
	WALL MOUNTED FAN / CABIN FAN	AS PER MTR. Clarification
	1x36 LED CEILING LIGHT FITTING RECESS/ SURFACE MOUNTED	—
	4/16 AMP SOCKET	—
	3X6A SOCKET AND 16A SWITCH WITH INDICATOR	4'-0"
	EXHAUST FAN	8'-0"

AC UNIT AND SOCKET		
	20A SINGLE POLE A/C SWITCH	—
	A/C SOCKET	—
	1.5 TR HIGH WALL SPLIT A/C UNIT	—
DATA AND VOICE SOCKET		
	DATA SOCKET	—
	VOICE SOCKET	—

ELECTRICAL WORK	
SYMBOL	ITEM NAME
	Computer Conducting and wiring ckts
	Data Conducting and wiring ckts
	Refrigerent Copper pipe
	AC Circuit wiring
	Computer UPS DB
	Light Points DB
	AC DB
	Tag Block
	Data Rack

**PROPOSED LAYOUT PLAN OF STATE BANK OF INDIA AT TUNGWALI**

TITLE:- <b>POINT LAYOUT PLAN</b>	DATE :-	05-10-2021	SIGNATURE AND SEAL FOR ARCHITECT
	SCALE:	N.T.S	
	DWG No.	DIC/40SBI/2K21/ELE/01	

**design innovations**  
 ARCHITECTS, INTERIOR DESIGNERS, PLANNERS  
 # 402 URBAN ESTATE PHASE II, BATHINDA  
 PH: 2212131 (C) 98154-01051 (M)



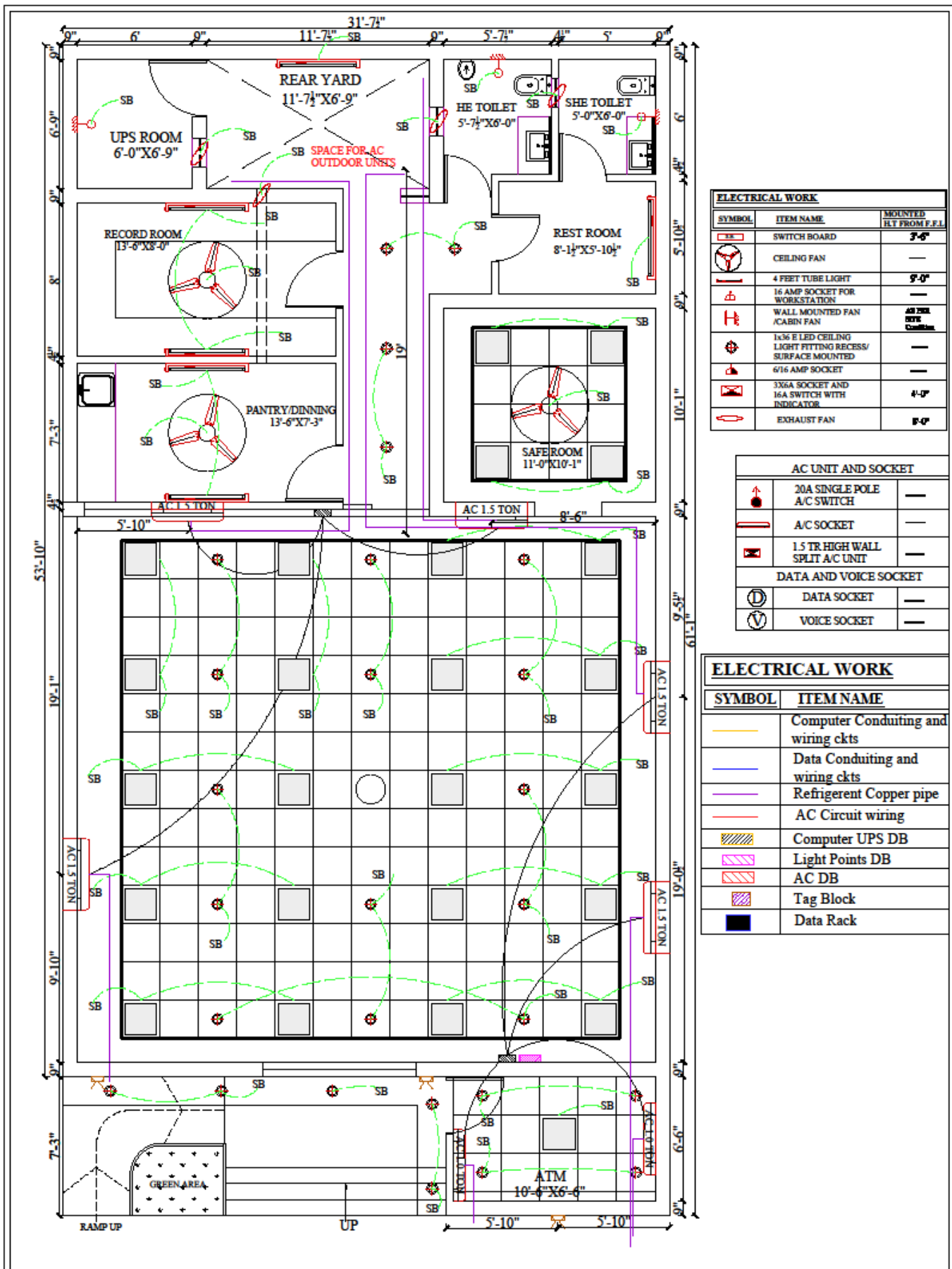

ELECTRICAL WORK		
SYMBOL	ITEM NAME	MOUNTED H/T FROM P.F.L
	SWITCH BOARD	3'-0"
	CEILING FAN	—
	4 FEET TUBE LIGHT	9'-0"
	16 AMP SOCKET FOR WORKSTATION	—
	WALL MOUNTED FAN / CABIN FAN	AS PER DBE Condition
	1x36 E LED CEILING LIGHT FITTING RECESS/SURFACE MOUNTED	—
	6/16 AMP SOCKET	—
	32xA SOCKET AND 16A SWITCH WITH INDICATOR	4'-0"
	EXHAUST FAN	8'-0"

AC UNIT AND SOCKET		
	20A SINGLE POLE A/C SWITCH	—
	A/C SOCKET	—
	1.5 TR HIGH WALL SPLIT A/C UNIT	—
DATA AND VOICE SOCKET		
	DATA SOCKET	—
	VOICE SOCKET	—

ELECTRICAL WORK	
SYMBOL	ITEM NAME
	Computer Conducting and wiring ckts
	Data Conducting and wiring ckts
	Refrigerent Copper pipe
	AC Circuit wiring
	Computer UPS DB
	Light Points DB
	AC DB
	Tag Block
	Data Rack

**PROPOSED LAYOUT PLAN OF STATE BANK OF INDIA AT TUNGWALI**

TITLE:-  
**LOOP POINT & AC COPPER PIPE**

DATE :- 05-10-2021  
SCALE: N.T.S  
DWG No. DIC/40SBI/2K21/ELE/02

SIGNATURE AND SEAL FOR ARCHITECT

**design innovations**  
ARCHITECTS, INTERIOR DESIGNERS, PLANNERS  
# 405 URBAN ESTATE PHASE II, SATYAPUR  
PH: 2212121 (D) 9815481061 (M)



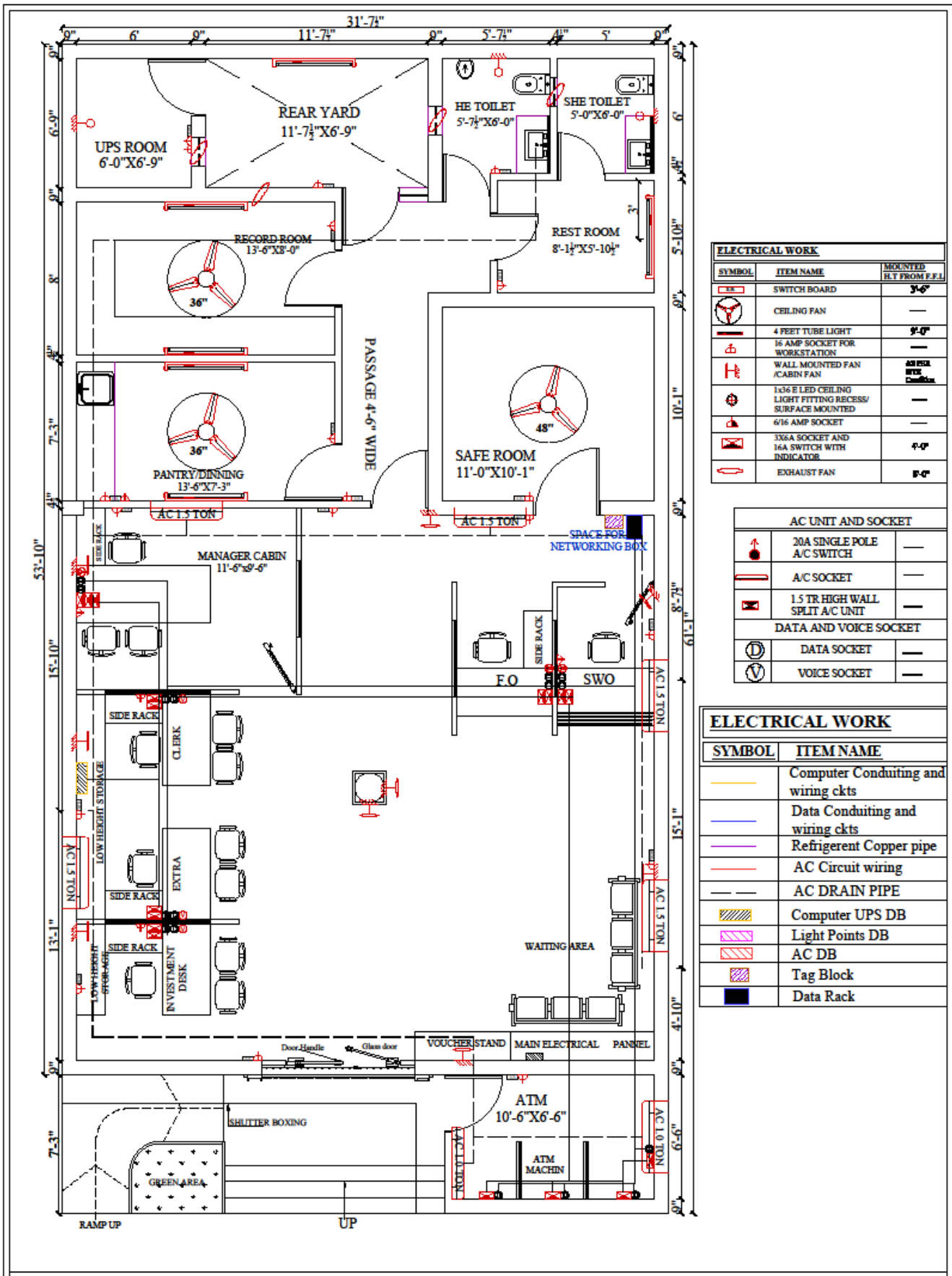

ELECTRICAL WORK		
SYMBOL	ITEM NAME	MOUNTED H/T FROM F.F.L
[Symbol]	SWITCH BOARD	3'-6"
[Symbol]	CEILING FAN	—
[Symbol]	4 FEET TUBE LIGHT	9'-0"
[Symbol]	16 AMP SOCKET FOR WORKSTATION	—
[Symbol]	WALL MOUNTED FAN / CABIN FAN	AS PER BFC Details
[Symbol]	1x36 E LED CEILING LIGHT FITTING RECESS/ SURFACE MOUNTED	—
[Symbol]	6/16 AMP SOCKET	—
[Symbol]	3X2A SOCKET AND 16A SWITCH WITH INDICATOR	4'-0"
[Symbol]	EXHAUST FAN	8'-0"

AC UNIT AND SOCKET		
[Symbol]	20A SINGLE POLE A/C SWITCH	—
[Symbol]	A/C SOCKET	—
[Symbol]	1.5 TR HIGH WALL SPLIT A/C UNIT	—
DATA AND VOICE SOCKET		
[Symbol]	DATA SOCKET	—
[Symbol]	VOICE SOCKET	—

ELECTRICAL WORK	
SYMBOL	ITEM NAME
[Symbol]	Computer Conduiting and wiring ckts
[Symbol]	Data Conduiting and wiring ckts
[Symbol]	Refrigerent Copper pipe
[Symbol]	AC Circuit wiring
[Symbol]	AC DRAIN PIPE
[Symbol]	Computer UPS DB
[Symbol]	Light Points DB
[Symbol]	AC DB
[Symbol]	Tag Block
[Symbol]	Data Rack

**PROPOSED LAYOUT PLAN OF STATE BANK OF INDIA AT TUNGWADI**

TITLE:-  
DATA CABLING

DATE :- 05-10-2021  
SCALE: N.T.S  
DWG No. DIC/40SBI/2K21/ELE/03

SIGNATURE AND SEAL FOR ARCHITECT

design innovations  
ARCHITECTS, INTERIOR DESIGNERS, PLANNERS  
# 405 URBAN ESTATE PHASE II, BATHINDA  
PH: 2212101 (3) 9015481051 (M)



