

- NOTES-**
1. REFER STAIR DRG. ALONG WITH THIS DRG.
  2. REFER DET OF BL/BLR/BLC IN STAIR DRG.
  3. REFER GENERAL NOTES DRG.
  4. PROVIDE CAMBER OF 20mm-25mm FOR CANTHILVER SLAB/BEAM WITH SPAN LESS THAN 6 FEET.
  5. PROVIDE CAMBER OF 30mm-40mm FOR CANTHILVER SLAB/BEAM MORE THAN 6 FEET OVER ALL WALLS.
  6. PROVIDE THROUGHOUT RCC LINTEL & SILL.
  7. CHECK THE STRUCTURAL DRG. WITH ARCH DRG. ELEVATION/SECTION/3D.
  8. IF ANY AMBIGUITY FOUND, CONTACT STRUCTURE ENGG. IMMEDIATELY BEFORE STARTING WORK.
  9. FOLLOW ONLY ARCHITECTURAL DIMENSIONS. STRUCTURE ENGINEER IS NOT RESPONSIBLE IF ANY ACCIDENT OCCURS ON SITE DUE TO CONSTRUCTION FAULTS.
  10. CHECK THE POSITION OF FC WITH ARCH DRG.
  11. GET IT APPROVED BY ARCHITECT BEFORE STARTING EXECUTION OF WORK.
  12. PROVIDE DRAINAGE PIPE AS PER PLUMBING CONSULTANT BEFORE CASTING SLAB & BEAM. NO CUTOUTS ARE ALLOWED AFTER CASTING SLAB/BEAM.
  13. MINIMUM CAMBER AT CENTER OF SIMPLY SUPPORTED BEAM (CAMBER IN MM) = SPAN(MM)/250
  14. MINIMUM CAMBER AT FREE END OF CANTILEVER IN (MM) = SPAN(MM)/50
  15. THIS STRUCTURE DRG IS BASED ON ARCH DRG SENT BY MAIL ON DATE: (26/01/2021) WORKING

16. MINIMUM CAMBER AT CENTER OF SIMPLY SUPPORTED BEAM (CAMBER IN MM) = SPAN(MM)/250
17. MINIMUM CAMBER AT FREE END OF CANTILEVER IN (MM) = SPAN(MM)/50
18. THIS STRUCTURE DRG IS BASED ON ARCH DRG SENT BY MAIL ON DATE: (26/01/2021) WORKING

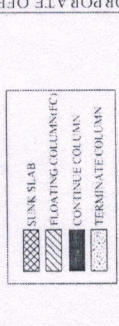

CONCRETE GRADE	GRADE
COLUMN	M25
SLAB	M25
BEAM	M25
RETAINING WALL	M25
USE STEEL GRADE FE-500LD	

**PROJECT NAME:-**  
SBI CORPORATE OFFICE

**ARCHITECT:-**  
MAMTA SHAH

**STRUCTURAL CONSULTANT:-**  
ZARNA ASSOCIATES  
STRUCTURAL CONSULTING ENGINEER  
SBI Finance Building, 10, Ashoka Road, Okhla, New Delhi

**APPROVED BY:-** VRP  
**CHECKED BY:-** RISHVA  
**DRAWN BY:-** BRUJESH  
**CORRECTED BY:-** VIJAY

**DATE:** 18-12-2023  
**PROJECT NO.:** 401/17  
**DRAWING TITLE:** LOWER BASEMENT SLAB

**DRG NO.:** 08  
**SCALE:** N.T.S  
**SHEET:** A3  
**N**

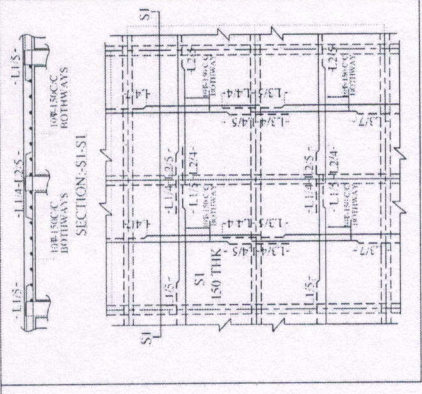

**300 THK. SLAB**

**150 THK. SLAB**

For ZARNA ASSOCIATES  
Structural Consultants  
Dr. V. R. PATEL  
P.A.D. (Str. Engrg.) M.E. (Str.) B.E. (Civil)

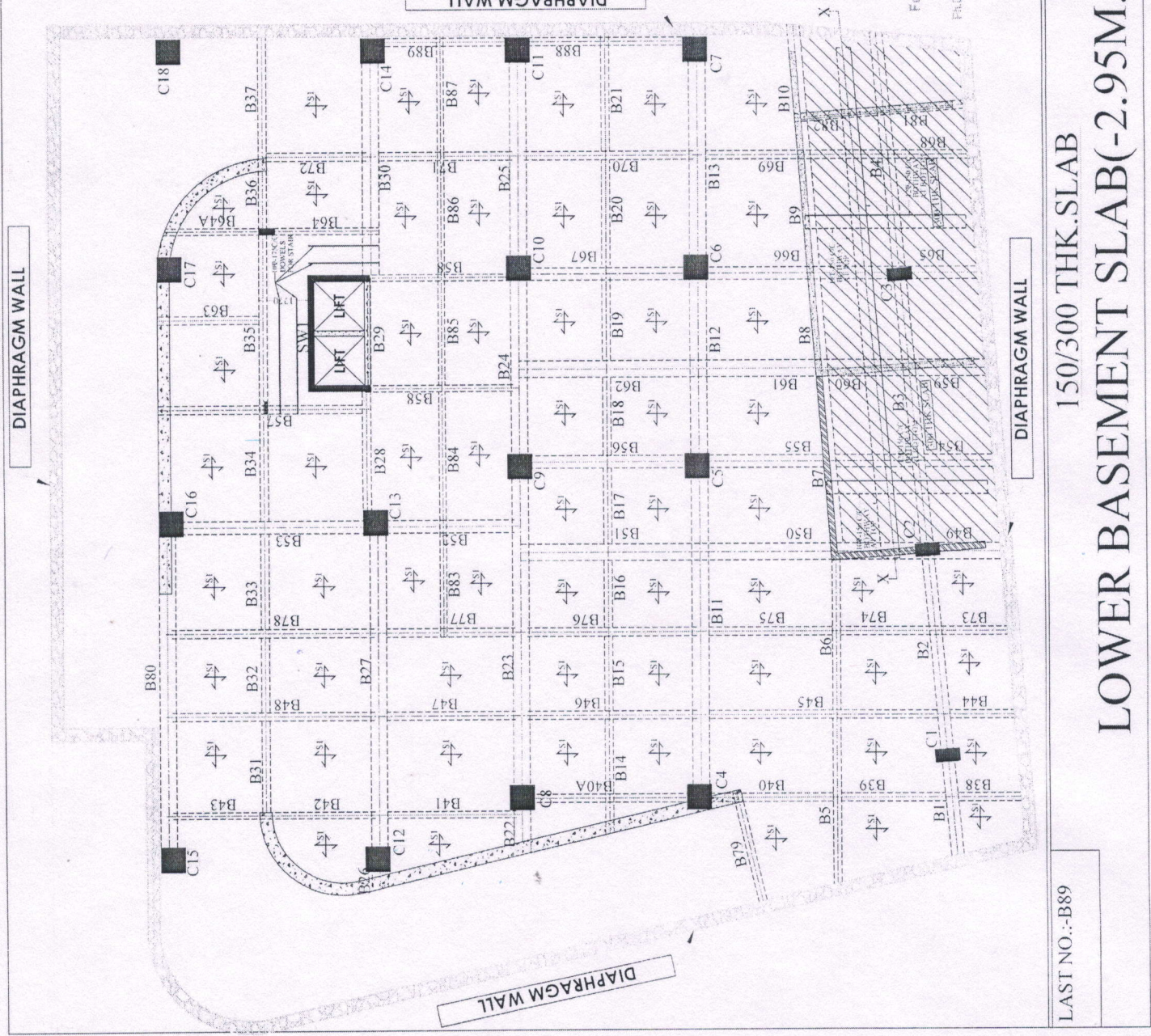

**150/300 THK. SLAB**

**LOWER BASEMENT SLAB(-2.95M.LVL.)**

LAST NO.:-B89

THIS DRAWING AND DESIGN IS PROPERTY OF ZARNA ASSOCIATES IT MUST NOT BE COPIED, REPRODUCED, OR TRANSMITTED IN ANY FORM OR BY ANY MEANS, WITHOUT THE WRITTEN PERMISSION.