

W  
FIRST FLOOR PLAN (SCALE 1:100)

NOTES:

1. THIS DRAWING IS ISSUED FOR VALIDATION ONLY AND SHOULD BE USED ONLY FOR THE PURPOSE IT IS ISSUED FOR.
2. ALL DIMENSIONS ARE FROM FINISHED TO FINISHED SURFACES.
3. DO NOT SCALE THIS DRAWING.
4. ALL DIMENSIONS ARE IN MM.

MITMITRA CONSULTANTS PVT.LTD. HOLDS THE COPYRIGHT OF THIS DESIGN AS PER THE INDIAN COPY RIGHT ACT, 1957 CLAUSE NO 17 & 18 IN THE CAPACITY OF THE AUTHOR. THIS DRAWING SHOULD NOT BE COPIED, REPRODUCED OR USED WITHOUT THE EXPRESS PERMISSION OF MCPL.

ISSUED ON	ISSUED TO	ISSUED FOR	COPIES
JOB NO: SB106	DRAWING NO: 01R1/TPH01	DATE: 14/11/2024	
DRAWN BY: PK	CHECKED BY: RJ	SCALE: 1:100	

PROJECT:  
**PROPOSED INTERIOR DESIGN SCHEME OF NEW SBI LOCAL HEAD OFFICE AT KHARADI, PUNE.**

MITMITRA CONSULTANTS  
MULTI DISCIPLINARY CONSULTANTS  
1st Floor, 'ARTHA 8008', 868/71-72, Senapati Bapat Road, Pune-411 016  
TEL - 25650218, 65202218 FAX - 25651228 E-MAIL - mitmitra@gmail.com

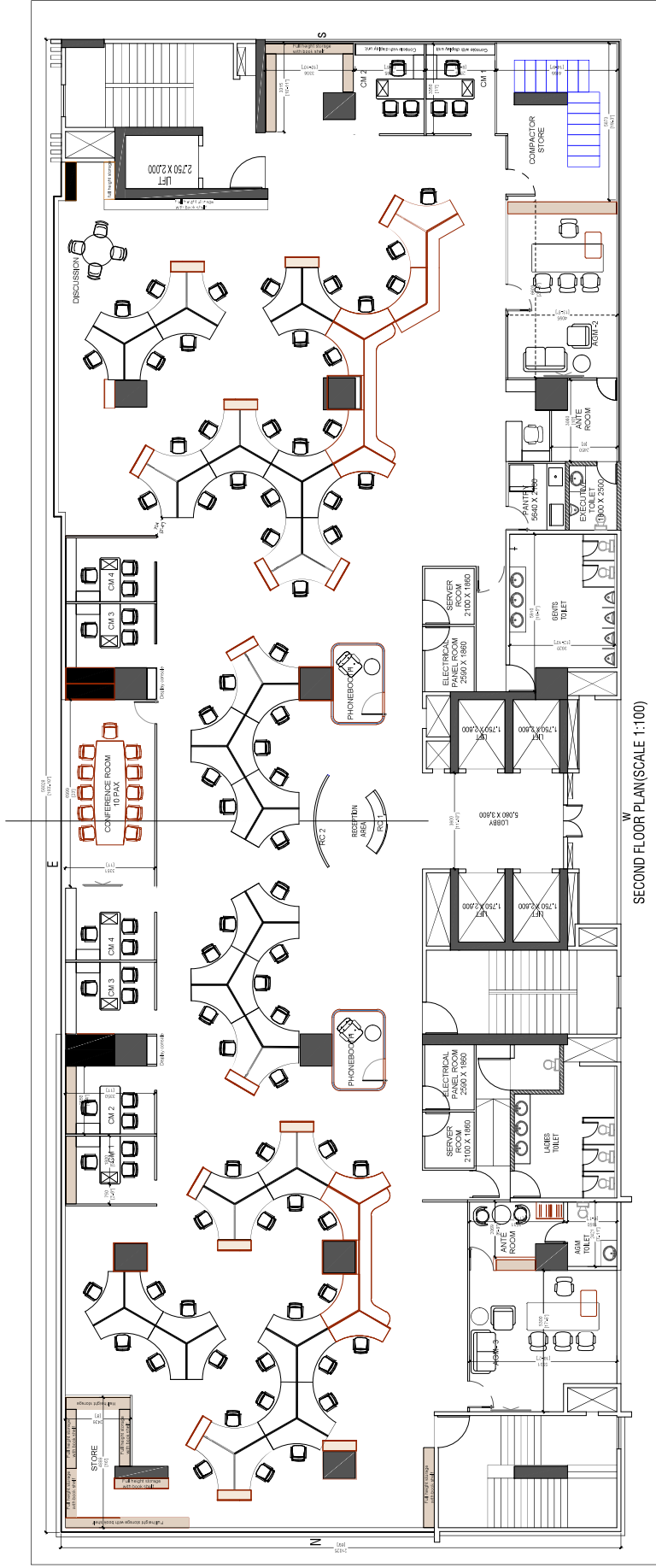

SECOND FLOOR PLAN (SCALE 1:100)

NOTES:

1. THIS DRAWING IS ISSUED FOR VALIDATION ONLY AND SHOULD BE USED ONLY FOR THE PURPOSE IT IS ISSUED FOR.
2. ALL DIMENSIONS ARE FROM FINISHED TO FINISHED SURFACES.
3. DO NOT SCALE THIS DRAWING.
4. ALL DIMENSIONS ARE IN MM.

MITMITRA CONSULTANTS PVT.LTD. HOLDS THE COPYRIGHT OF THIS DESIGN AS PER THE INDIAN COPY RIGHT ACT, 1957 CLAUSE NO 17 & 18 IN THE CAPACITY OF THE AUTHOR. THIS DRAWING SHOULD NOT BE COPIED, REPRODUCED OR USED WITHOUT THE EXPRESS PERMISSION OF MCPL.

ISSUED ON	ISSUED TO	ISSUED FOR	COPIES
JOB NO: SB106	DRAWING NO: 02R1/ITPh02	DATE: 14/11/2024	
DRAWN BY: PK	CHECKED BY: RJ	SCALE: 1:100	

PROJECT:  
**PROPOSED INTERIOR DESIGN SCHEME OF NEW SBI LOCAL HEAD OFFICE AT KHARADI, PUNE.**

MITMITRA CONSULTANTS  
MUMBAI OFFICE: 101, MIDC, PHASE-1, CHANDRANAGAR, VALVES  
1st Floor, 'ARTHA ROAD', 868/71-72, Senapati Bapat Road, Pune-411 016  
TEL - 25650218, 65220218 FAX - 25651278 E-MAIL - mitmitra@gmail.com

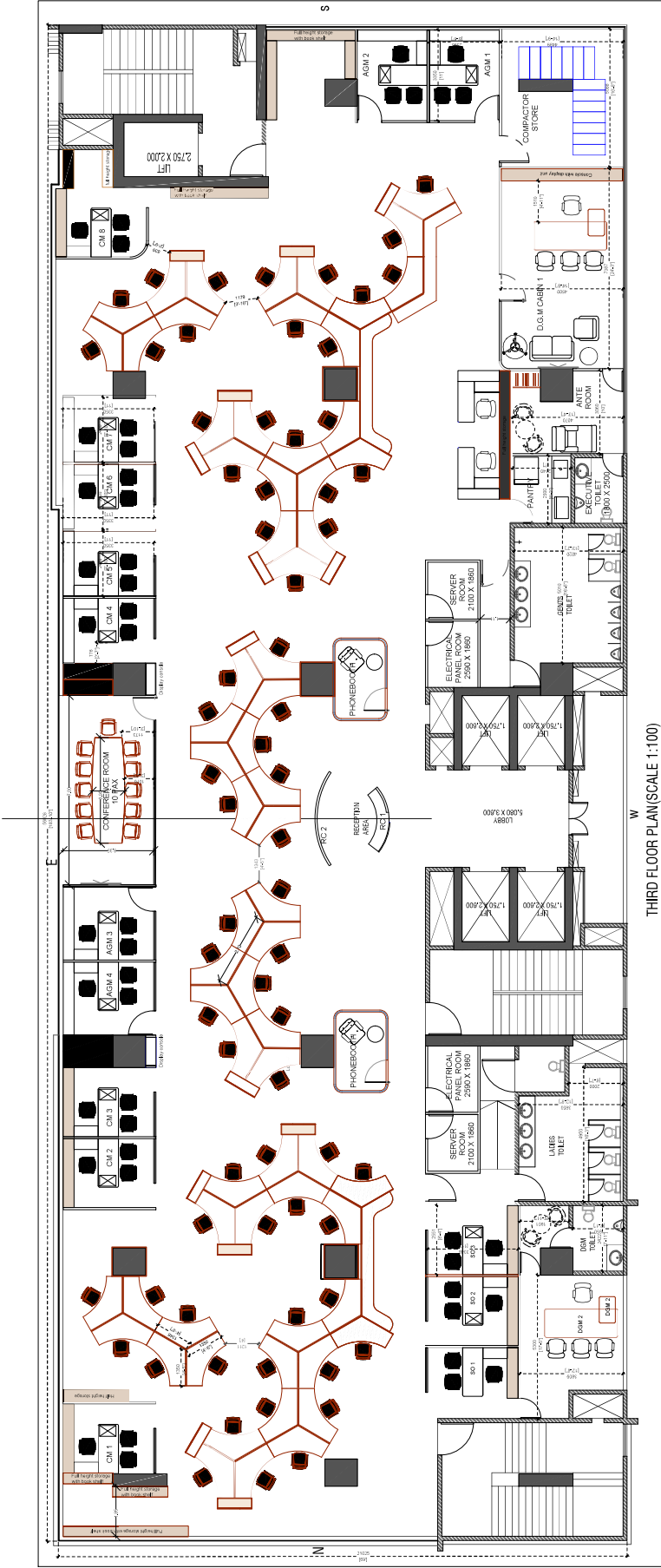

W  
THIRD FLOOR PLAN (SCALE 1:100)

NOTES:

1. THIS DRAWING IS ISSUED FOR VALIDATION ONLY AND SHOULD BE USED ONLY FOR THE PURPOSE IT IS ISSUED FOR.
2. ALL DIMENSIONS ARE FROM FINISHED TO FINISHED SURFACES.
3. DO NOT SCALE THIS DRAWING.
4. ALL DIMENSIONS ARE IN MM.

MITMITRA CONSULTANTS PVT.LTD. HOLDS THE COPYRIGHT OF THIS DESIGN AS PER THE INDIAN COPY RIGHT ACT, 1957 CLAUSE NO 17 & 18 IN THE CAPACITY OF THE AUTHOR. THIS DRAWING SHOULD NOT BE COPIED, REPRODUCED OR USED WITHOUT THE EXPRESS PERMISSION OF MCPL.

ISSUED ON	ISSUED TO	ISSUED FOR	COPIES
JOB NO: <b>SB106</b>	DRAWING NO: <b>03R1/TPH03</b>	DATE: <b>14/11/2024</b>	
DRAWN BY: <b>PK</b>	CHECKED BY: <b>RJ</b>	SCALE: <b>1:100</b>	

PROJECT:  
**PROPOSED INTERIOR DESIGN SCHEME OF NEW SBI LOCAL HEAD OFFICE AT KHARADI, PUNE.**

MITMITRA CONSULTANTS  
MUMBAI OFFICE: 101, MIDC AREA, VALVERS  
1st Floor, 'ARTHA 800H' 868/71-72, Senapati Bapat Road, Pune-411 016  
TEL - 25540218, 65220218 FAX - 25551278 E-MAIL - mitmitra@gmail.com