

PROPOSED INTERIORS / RENOVATION WORK FOR STATE BANK OF INDIA, B.O. & PROPOSED INTERIORS FOR WEALTH - SIGNATURE LOUNGE AT B.O.- SME , KANAK MANDI, HOSIARPUR (PB).

**LEGEND**

S.NO.	DESCRIPTION	SYMBOL	HEIGHT
01.	FAN POINT WITH HOOK		CEILING - IN SLAB
02.	LIGHT POINT		CEILING - SLAB SURFACE MOUNTED
03.	BRACKET LIGHT		+7'6"
04.	SWITCH BOARD WITH 5amp. SOCKET		+ 5'0"
05.	5amp. SOCKET		WALL- : + 5'0" FOR EX. + 7'6"
06.	5amp. SOCKET WITH SWITCH		WALL- : + 5'0"
07.	15amp. SOCKET WITH SWITCH /RAW P.P.		WALL- : + 5'0"
08.	EXHAUST FAN		+7'0" OR AS/SITE
09.			
10.	ELECTRICAL CONTROL PANEL		AE PER LAYOUT PLAN

**NOTE-**

- 01. BOTTOM LVL. OF DB IS +5'0".
- 02. BOTTOM LVL. OF SWITCH BOARDS OF G.LIGHTING IS +4'6".
- 03. WALL FAN POINT AT +6'0" & COLOUR IS WHITE.

**NOTE-**

1. NO CEILING/ FALSE CEILING SHALL BE PROVIDED IN TOILETS, PANTRY, SAFE ROOM, UPS ROOM, RECORD ROOM, CURRENCY CHEST & STATIONERY ROOM SHOULD BE AS PER DRG.

2. CEILING/ FALSE CEILING SHALL BE PROVIDED IN BANKING HALL OR PUBLIC AREA ONLY.

3. MINERAL FIBRE CEILING- SHOULD BE PROVIDED WHERE EVER SPECIFIED.

4. =====  
PARTITION / FURNITURE LAYOUT BELOW

5. CLEAR HEIGHT AS PER SITE FROM FINISH FLOOR TO BOTTOM OF SLAB

7. ROUND LIGHT-15W/5W

8. SQUARE LIGHT- 600MM X 600MM

9. AIRCONDITIONED (C.U.)

10. GRID TILE - ARMSTRONG 600MM X600MM X16 MM PRIMA SAND SUPREME, RH 99.

REV.	DESCRIPTION	DATE
TITLE: REFLECTED CEILING PLAN & CEILING & GENERAL LIGHTING		

SCALE	1"=8'-0"
DATE	01/03/24
JOB NO.	SBI-SMEH/01
DRG. NO.	WD-03

**CREATIVE CONCEPTS**  
ARCHITECTS, PLANNERS, INT. DESIGNERS  
RESI.C.O. - 1350, SECTOR - 25  
PANCHKULA- 134116.  
PH. 09815788192 (M)

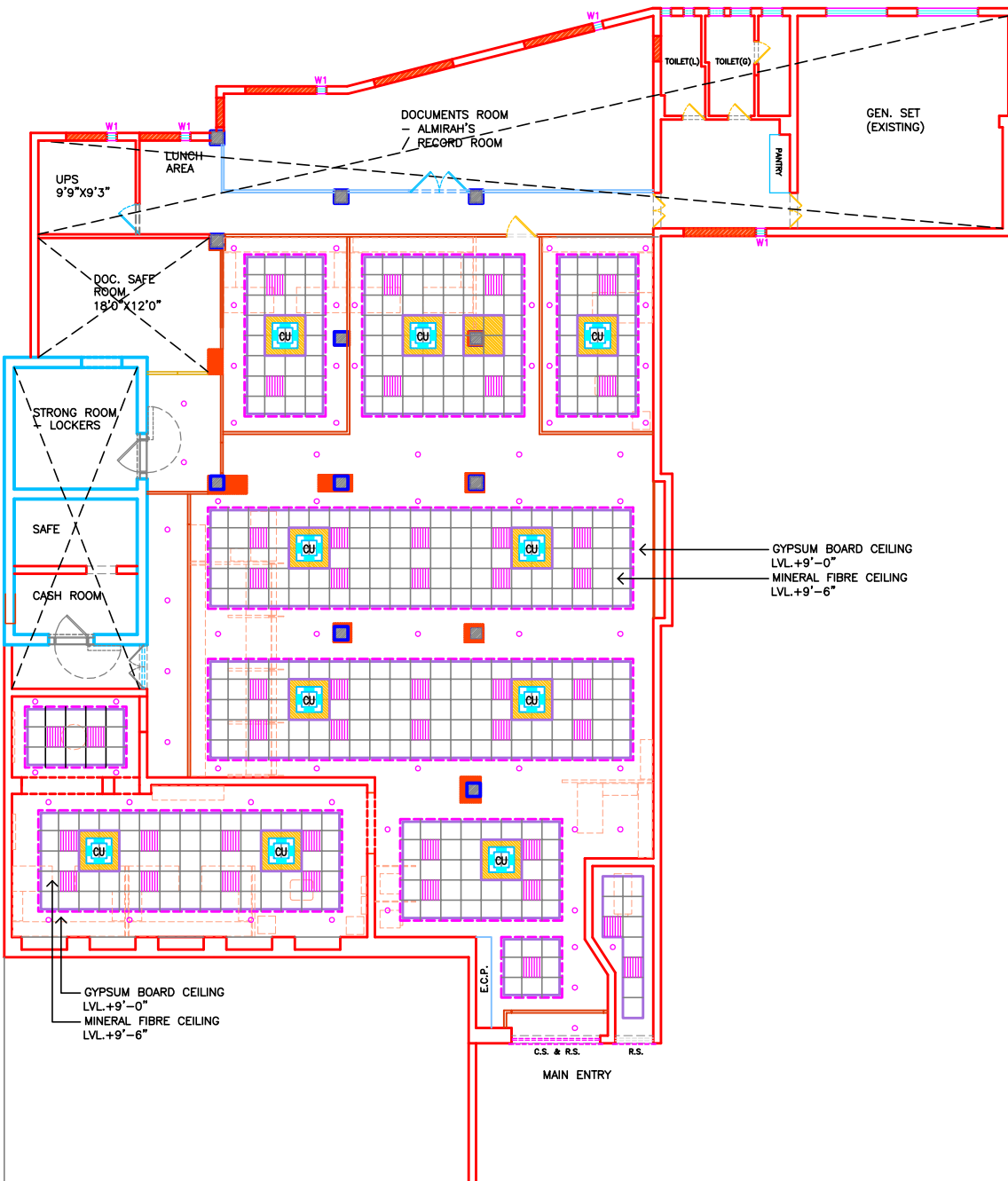

LAYOUT PLAN - G.F.

